

INDEX	SD-0
INDEX	SD-1
INSTALLATION INSTRUCTIONS	SDI-1
INSTALLATION INSTRUCTIONS	SDI-2
INSTALLATION INSTRUCTIONS	SDI-3
INSTALLATION INSTRUCTIONS	SDI-4
INTRODUCTION TO TYPICAL DETAILS	SD-2
OVERVIEW S-DECK SYSTEM	SD-3
EAVE DETAIL; SOLID SHEATHING	SD-10
EAVE DETAIL; OPEN FRAMING	SD-11
EAVE DETAIL; W/S-DECK WALL PANEL; SOLID SHEATHING	SD-12
HIP RIDGE; SOLID SHEATHING	SD-20
SHED ROOF RIDGE	SD-21
HIP RIDGE; OPEN FRAMING	SD-22
RIDGE; TERMINATION AT DORMER VALLEY	SD-23
GABLE;	SD-30
GABLE; WITH S-DECK WALL PANEL	SD-31
GABLE; WITH WALL PANEL	SD-32
GABLE; CURVED S-DECK	SD-33
HEAD WALL; WITH PARAPET	SD-40
HEAD WALL; WITH S-DECK	SD-41
HEAD WALL; WITH REGLET	SD-42
RAKE WALL; WITH WALL PANEL	SD-50
RAKE WALL; WITH S-DECK WALL PANEL	SD-51
RAKE WALL; WITH REGLET	SD-52
RAKE WALL; WITH PARAPET	SD-53
RAKE WALL; OPEN FRAMING; S-DECK WALL PANEL	SD-54
RAKE WALL; CURVED S-DECK; WITH WALL PANEL	SD-55
SLOPE TRANSITION WITH FLASHING	SD-60
VALLEY	SD-70
VALLEY; OPEN FRAMING	SD-71
ROOF PENETRATION; PIPE PENETRATION	SD-80



**Berridge  
Manufacturing  
Company**

INDEX

**S-DECK SYSTEM**

DATE: 11/20/00

PAGE\FILE  
**SD-0**

ROOF PENETRATION; SQUARE (PLAN VIEW)	SD-81
ROOF PENETRATION; SIDE A	SD-82
ROOF PENETRATION; SIDE B	SD-83
ROOF PENETRATION; SIDE C	SD-84
ROOF PENETRATION; LARGER THAN 4"; OPEN FRAMING	SD-85
INSIDE CORNER; SOLID SHEATHING	SD-90
OUTSIDE CORNER; SOLID SHEATHING	SD-91
INSIDE CORNER; OPEN FRAMING	SD-92
OUTSIDE CORNER; OPEN FRAMING	SD-93
INSIDE CORNER; SOLID SHEATHING; HORIZONTAL	SD-94
OUTSIDE CORNER; SOLID SHEATHING; HORIZONTAL	SD-95
HEAD DETAIL; SOLID SHEATHING	SD-96
SLAB DETAIL; SOLID SHEATHING	SD-97
SILL DETAIL; SOLID SHEATHING	SD-98
JAMB DETAIL; SOLID SHEATHING	SD-99

DATE: 11/20/00

INDEX

PAGE\FILE  
SD-I

**S-DECK SYSTEM**



**Berridge  
Manufacturing  
Company**

*Roofs of Distinction*

- A. BERRIDGE S-DECK PANEL: THE BERRIDGE S-DECK PANEL IS FACTORY FABRICATED TO A CONSTANT CORRUGATION DEPTH OF 7/8" AND A NOMINAL PANEL COVERAGE OF 32" OR 34.667".

PANEL MAY BE ORDERED FROM THE FACTORY STRAIGHT OR CURVED (MINIMUM RADIUS 5'-0"). USE ICE AND WATERSHIELD AS UNDERLAYMENT UNDER CURVED ROOF.

PANELS ARE FABRICATED TO A MINIMUM LENGTH OF 5'-0" AND A MAXIMUM LENGTH OF 40'-0".

- B. MINIMUM SLOPE: THE S-DECK PANEL IS RECOMMENDED FOR ROOF SLOPES OF 3 ON 12 OR GREATER. SLOPES LESS CONSULT BERRIDGE MANUFACTURING COMPANY.
- C. MATERIAL STORAGE: CAUTION MUST BE EXERCISED IN STORAGE OF MATERIAL PRIOR TO INSTALLATION. KEEP ALL BERRIDGE PREFINISHED MATERIAL IN A DRY LOCATION WITH ADEQUATE VENTILATION AND OUT OF DIRECT SUNLIGHT.

EXPOSURE TO DIRECT SUNLIGHT AND/OR MOISTURE MAY CAUSE THE FACTORY APPLIED STRIPPABLE PLASTIC FILM TO ADHERE TO THE METAL PERMANENTLY AND DISCOLOR THE FINISH. IF THIS SHOULD OCCUR THE PAINT WARRANTY WILL BE VOID.

- D. STRIPPABLE FILM: THE STRIPPABLE PLASTIC FILM, WHICH IS APPLIED OVER MOST BERRIDGE PREFINISHED PRODUCTS, PANELS, FLASHINGS, COILS AND FLAT SHEETS, PROVIDES PROTECTION OF THE FINISH DURING FABRICATION AND TRANSIT. THIS FILM MUST BE REMOVED PRIOR TO INSTALLATION.
- E. SOLID SHEATHING REQUIREMENTS: BERRIDGE MANUFACTURING COMPANY RECOMMENDS THE USE OF EITHER BERRIDGE 24 GA. CORRUGATED SHEATHING (NOMINAL 2 1/2" PITCH BY 7/8" DEPTH) OR A MINIMUM OF 1/2" PLYWOOD SHEATHING TO PROVIDE SUFFICIENT HOLDING POWER FOR FASTENERS. CONTACT BERRIDGE MANUFACTURING'S ENGINEERING DEPARTMENT FOR USE OF ANY OTHER TYPE OF SOLID SHEATHING. (# 30 FELT UNDERLAYMENT OR EQUAL MUST BE USED OVER ANY SOLID SHEATHING).

DUE TO # 30 FELTS TENDENCY TO TEAR WHEN USED OVER CORRUGATED DECKING, BERRIDGE MANUFACTURING RECOMMENDS GRACE ICE AND WATERSHIELD OR EQUAL TO BE USED AS AN UNDERLAYMENT FOR ALL CORRUGATED DECKS.

- F. SHEATHING INSPECTION:

1. SHEATHING END JOINTS SHOULD BE STAGGERED.
2. ALL END JOINTS SHOULD MEET AT EITHER A JOIST OR RAFTER.
3. BLOCKING OF "H" CLIPS SHOULD BE USED IF JOINTS DO NOT REMAIN FLAT UNDER THE WEIGHT OF WORKMEN.
4. USE SHIMS TO KEEP ENTIRE SUBSTRATE EVEN; UNEVEN SUBSTRATE WILL RESULT IN "OIL-CANNING" IN THE PANELS. SUBSTRATE SHOULD BE LEVEL TO 1/4" IN 20'-0".
5. ALL CUTS AT PENETRATIONS SHOULD BE TIGHT, WITHOUT GAPS.
6. USE WOOD FRAMED CRICKETS AT LARGE PENETRATIONS.
7. MAKE SURE SUBSTRATE JOINTS ARE TIGHT AT ALL HIPS, VALLEYS AND RIDGES.

- G. INSTALLATION OVER OPEN FRAMING: REFER TO ALLOWABLE UNIFORM LOAD TABLE PAGE SD-3.

FOR DIAPHRAGM CAPABILITIES OF "S" DECK CONSULT BERRIDGE TECHNICAL DEPT. PURLIN OR OTHER STRUCTURAL BRACING IS THE RESPONSIBILITY OF OTHERS.

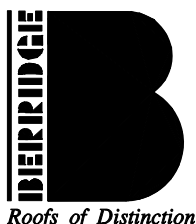

**Berridge  
Manufacturing  
Company**

## INSTALLATION INSTRUCTIONS

# S-DECK SYSTEM

DATE: 05/14/09

PAGE\FILE  
SDI-I

H. OPEN FRAMING INSPECTION:

1. PURLINS SHOULD BE ALIGNED WITH TOP FLANGES IN THE SAME PLANE TO A TOLERANCE OF 1/4" IN 20'-0". UNEVENNESS IN THE TOP PLANE OF THE PURLINS WILL RESULT IN ABNORMAL "OIL CANNING" OF PANELS. PURLINS SHALL BE ADEQUATELY BRACED.
2. BERRIDGE MANUFACTURING COMPANY RECOMMENDS SOLID SHEATHING IN VALLEY AND AROUND ROOF PENETRATIONS. DO NOT APPLY PANELS ON OPEN FRAMING AT VALLEYS OR ROOF PENETRATIONS WITHOUT REFERRING TO DETAILS SD-71 AND SD-85.
3. FOOT TRAFFIC ON THE PANELS MUST BE KEPT TO A MINIMUM. ARCHITECTURAL PANELS ARE DESIGNED FOR AESTHETICS AND CAN BE EASILY DAMAGED OR DEFORMED IF EXTREME CARE IS NOT USED.

I. FASCIA/RAKE INSPECTION:

1. STRIKE A LINE THE FULL LENGTH OF THE FASCIA OR RAKE. IF NOT STRAIGHT, CORRECT WITH SHIMS.
2. MAKE SURE FASCIA/RAKE IS FLUSH WITH SHEATHING.

J. FELT UNDERLAYMENT: A SINGLE LAYER OF NUMBER THIRTY FELT UNDERLAYMENT (OR EQUAL) MUST BE APPLIED OVER SOLID SHEATHING, AS SHOWN IN THE BERRIDGE MANUFACTURING COMPANY TYPICAL FELTING DETAILS. THE USE OF ADDITIONAL LAYERS OF NUMBER THIRTY FELT IS RECOMMENDED ON LOW SLOPED ROOFS, AT ALL VALLEY CONDITIONS, AT ROOF PENETRATIONS AND AT CERTAIN OTHER FLASHING CONDITIONS AS DEPICTED IN THE S-DECK PANEL TYPICAL DETAILS.

GRACE ICE AND WATERSHIELD MAY BE REQUIRED ON LOW SLOPED ROOFS OR AT CERTAIN FLASHING CONDITIONS.

K. FELTING INSTALLATION:

1. DO NOT USE RED ROSIN PAPER UNDER METAL ROOFING PANELS.
2. SWEEP ROOF AREA CLEAN.
3. USE FLAT HEAD GALVANIZED ROOFING NAILS 1 1/4" LONG WITH BERRIDGE GALVANIZED FELT CAPS.
4. INSTALL VALLEY FELT FIRST.
5. INSTALL FELT PARALLEL TO THE EAVE, (2 LAYERS REQUIRED AT EAVE) STARTING AT EAVE AND USING MINIMUM 6" LAPS. USE 2 LAYERS OF FELT ON ENTIRE ROOF DECK IF ROOF SLOPE IS 3 ON 12.
6. REFER TO FELTING DETAILS WHEN VALLEYS OR ROOF PENETRATIONS ARE INVOLVED ON OPEN FRAMING CONDITIONS.
7. INSULATE BETWEEN WOOD BLOCKING AND METAL WITH FELT OR GRACE ICE AND WATERSHIELD
8. USE GRACE ICE AND WATERSHIELD AS UNDERLAYMENT FOR CURVED ROOFS.
9. VERIFY CORRECT METHOD OF INSTALLING ICE AND WATERSHIELD WITH ICE AND WATERSHIELD MANUFACTURE.

L. ELECTROLYSIS: AVOID ALLOWING FLASHINGS AND PANELS TO COME INTO CONTACT WITH EITHER LEAD, COPPER, OR OTHER DISSIMILAR METALS AND PREVENT EXPOSURE TO WATER RUNDOWN FROM COPPER AND/OR LEAD.

M. SEALANT RECOMMENDATIONS: TREMCO, INC. SPECTREM 1 SILICONE SEALANT. DO NOT USE CLEAR CAULK.

DATE: 11/20/00

INSTALLATION  
INSTRUCTIONS

PAGE\FILE  
SDI-2

S-DECK SYSTEM



Berridge  
Manufacturing  
Company

Roofs of Distinction

N. FLASHING: IF BERRIDGE MANUFACTURING COMPANY IS TO SUPPLY FLASHING, ALL FLASHINGS WILL BE FABRICATED IN 10'-0" LENGTHS WITH SQUARE END CUTS ONLY. THE PURCHASER MUST PROVIDE ALL DIMENSIONS AND DEGREES OF ANGLE.

O. FLASHING INSTALLATION:

1. REMOVE STRIPPABLE PLASTIC FILM FROM ALL FLASHINGS PRIOR TO INSTALLATION.
2. ALWAYS STAGGER JOINTS WHEN ONE FLASHING IS INSTALLED OVER OTHER FLASHINGS.
3. INSTALL ALL FLASHINGS AS PER BERRIDGE TYPICAL DETAILS.
4. ALL FLASHINGS ARE TO BE DESIGNED AND INSTALLED TO AVOID TRAPING WATER.

P. PANELS: BERRIDGE MANUFACTURING COMPANY WILL PROVIDE SQUARE END CUTS ONLY ON ALL S-DECK PANELS. COMPUTATION OF ALL QUANTITIES AND DIMENSIONS ARE THE RESPONSIBILITY OF THE PURCHASER.

Q. PANEL INSTALLATION:

1. REMOVE STRIPPABLE PLASTIC FILM FROM EACH PANEL PRIOR TO INSTALLATION.
2. START AT ONE GABLE END OF THE ROOF AND WORK TOWARD THE OTHER GABLE.
3. EACH PANEL IS TO BE KEPT TIGHT AGAINST THE ADJOINING PANEL. NEVER PERMIT A GAP BETWEEN VERTICAL LAP. ANY CRIMPS OR BENDS MUST BE STRAIGHTENED PRIOR INSTALLATION.
4. KEEP PANELS ALIGNED SO THAT RIBS MATCH AT HIPS, VALLEYS AND WHERE VERTICAL PANELS ADJOIN ROOF PANELS. DO NOT INSTALL LONG CONTINUOUS RUNS OF PANELS ALL AT ONE TIME WHERE RIB LINES MUST MATCH. INSTALL TEN OR TWELVE PANELS IN ONE ELEVATION AND THEN FOLLOW WITH A LIKE NUMBER OF PANELS ON THE OTHER ELEVATION. WHEN YOU INSTALL PANELS IN THIS MANNER, YOU WILL BE ABLE TO MAKE ANY ADJUSTMENTS REQUIRED TO INSURE RIB MATCHING.
5. COPPER-COTE™ CHAMPAGNE, LEAD-COTE™ AND PREWEATHERED GALVALUME®  
PANEL INSTALLATION: NOTE THE SERIES OF ARROWS PAINTED ON THE UNDERSIDE OF THE PANEL. ALL PANELS MUST BE INSTALLED IN A CONSISTENT MANNER, MEANING THAT THE ARROWS ON EVERY PANEL ARE ALL POINTING IN THE SAME DIRECTION. IF A PANEL IS REVERSED (ARROWS POINTING OPPOSITE OF THOSE ON OTHER PANELS) IT WILL APPEAR, FROM A DISTANCE, A DIFFERENT SHADE DUE TO THE GRANULAR EFFECT OF THE PIGMENTS IN THE FINISH. METALLIC FINISHES ARE MATCH - LOT FINISHES. DO NOT MIX LOTS.

R. FASTENERS: INSTALL FASTENERS AS PER TYPICAL DETAILS. USE #10 HEX HEAD ZINC PLATED FASTENER WITH METAL BACKED NEOPRENE FASTENER WHEN FASTENING TO WOOD. USE #12 HEX HEAD ZINC PLATED FASTENER WITH A METAL BACKED NEOPRENE WASHER WHEN FASTENING TO METAL \* WHEN USING POP RIVETS ON FLASHING, STAINLESS STEEL RIVETS ARE RECOMMENDED TO AVOID RUST STAINS.

MAKE SURE ALL FASTENERS ARE DRIVEN STRAIGHT AND SET FLAT. DO NOT OVERDRIVE FASTENERS AS THIS WILL CAUSE THE CLIP AND/OR FLASHINGS TO BUCKLE OR BECOME RECESSED BELOW THE ELEVATION OF THE SUBSTRATE.

\* CONSULT BERRIDGE MANUFACTURING'S ENGINEERING DEPARTMENT REGARDING FASTENER SPACING TO MEET DESIGN CRITERIA AND THE USE OF ANY OTHER TYPE OF FASTENER.



**Berridge  
Manufacturing  
Company**

## INSTALLATION INSTRUCTIONS

# S-DECK SYSTEM

DATE: 11/20/00

PAGE\FILE  
SDI-3

BERRIDGE MANUFACTURING COMPANY STRIVES TO PROVIDE ITS CUSTOMERS WITH THE HIGHEST QUALITY STRETCHER LEVELED STEEL AVAILABLE. THE LATEST TECHNOLOGY IS ALSO INCORPORATED IN BERRIDGE'S HIGH-PRECISION COIL HANDLING AND ROLL FORMING EQUIPMENT TO MINIMIZE THE STRESS ON METAL DURING PRODUCTION. FURTHERMORE, BERRIDGE UTILIZES HEAVIER 24 GAUGE METAL RATHER THAN 26 GAUGE STEEL OR LIGHT GAUGE ALUMINUM AS OFFERED BY MANY COMPETITORS. ALL THESE MEASURES HAVE BEEN TAKEN TO MINIMIZE THE AMOUNT OF "OIL-CANNING" (WAVINESS) WHICH IS NATURALLY INHERENT IN FLAT SHEET METAL. MANY TIMES, HOWEVER, THE CAUSE OF WAVINESS OR "OIL-CANNING" CAN BE TRACED TO UNEVEN SHEATHING, IMPROPER FELT INSTALLATION, OR, IN THE CASE OF OPEN FRAMING, UNEVENNESS OF THE TOP PLANE OF THE PURLINS OR FOOT TRAFFIC ON THE PANELS.

ALL ARCHITECTURAL PANELS REQUIRE CARE IN HANDLING AND INSTALLATION TO AVOID DAMAGING OR DEFORMING THE PANELS.

THESE INSTALLATION INSTRUCTIONS AND THE FOLLOWING TYPICAL DETAILS ARE INTENDED TO PROVIDE OUR CUSTOMERS WITH THE INFORMATION REQUIRED FOR AN AESTHETICALLY PLEASING AND FUNCTIONAL INSTALLATION OF THE BERRIDGE S-DECK PANEL SYSTEM.

NOTE: ALL PRODUCT SPECIFICATIONS, DETAILS AND INSTALLATION INSTRUCTIONS SUBJECT TO CHANGE WITHOUT NOTICE. FOR SPECIFIC PROJECT DETAILS, CONTACT BERRIDGE.

DATE: 11/20/00

PAGE\FILE  
SDI-4

## INSTALLATION INSTRUCTIONS

# S-DECK SYSTEM



**Berridge  
Manufacturing  
Company**

THE DETAILS CONTAINED IN THE FOLLOWING PAGES ARE MERELY RECOMMENDATIONS AS TO HOW BERRIDGE MANUFACTURING MATERIALS SHOULD BE INSTALLED. THEY MAY REQUIRE ADAPTATIONS OR MODIFICATIONS FOR A SPECIFIC PROJECT AS CONDITIONS VARY IN BOTH BUILDING DESIGN AND LOCAL WEATHER PECULIARITIES.

BERRIDGE MANUFACTURING COMPANY SHALL BE HELD HARMLESS FROM ANY AND ALL CLAIMS ARISING FROM LACK OF WATERTIGHTNESS AS A RESULT OF FOLLOWING THESE RECOMMENDED DETAILS. ENSURING WATERTIGHTNESS ON ANY GIVEN PROJECT IS THE FUNCTION OF THE INSTALLER. THE ARCHITECT/GENERAL CONTRACTOR/INSTALLER MUST ACCEPT THE RESPONSIBILITY TO ADAPT THESE DETAILS TO MEET PARTICULAR BUILDING REQUIREMENTS AND TO ASSURE ADEQUATE WATERTIGHTNESS.

THE INSTALLER CAN VIRTUALLY ASSURE WATERTIGHTNESS IF THESE FLASHING DETAILS HAVE BEEN PROPERLY ADAPTED, ADEQUATE LAPS HAVE BEEN PROVIDED, CORRECT TYPE OF SEALANT USED, ALL JOINTS ADEQUATELY CAULKED, AND PROFESSIONAL WORKMANSHIP EMPLOYED.



**Berridge  
Manufacturing  
Company**

## INTRODUCTION TO TYPICAL DETAILS

# S-DECK SYSTEM

DATE: 11/20/00

PAGE\FILE

SD-2

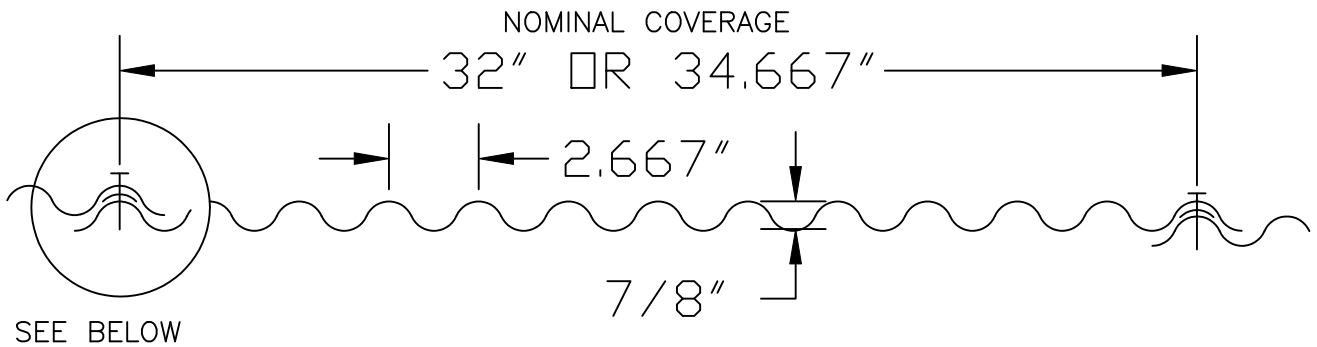

#### SECTION PROPERTIES

GAGE	THICKNESS	WT. (PSF)	FY (KSI)	IX (IN <sup>4</sup> /FT)	MA (FT-LBS/FT)
	INCHES (STEEL)				
24	.0239	1.24	40	0.0194	103.7

#### ALLOWABLE UNIFORM LOADS (PSF)

THICKNESS (INCHES)	DEAD + LIVE LOAD (STRESS)					LIVE LOAD DEFL (L/240)				
	3'-0	3'-6	4'-0	4'-6	5'-0	3'-0	3'-6	4'-0	4'-6	5'-0
.0239	104	77	58	46	37	88	55	37	25	20

1. SECTION PROPERTIES AND ALLOWABLE STRESSES HAVE BEEN CALCULATED IN ACCORDANCE WITH 1986 AISI SPECIFICATIONS FOR THE DESIGN OF COLD-FORMED STEEL STRUCTURAL MEMBERS.
2. PANEL STEEL CONFORMS TO ASTM A653 GRADE C.
3. VALUES SHOWN AS ALLOWABLE LOADS ARE BASED ON PANELS COVERING THREE EQUAL CONTINUOUS SPANS. MULTIPLY THE VALUES BY 0.8 FOR TWO SPAN ALLOWABLE LOADS.
4. THE PANEL WEIGHT HAS BEEN DEDUCTED FROM THE ALLOWABLE LOAD TABLES.
5. THE ALLOWABLE LOADS SHOWN ABOVE MAY BE INCREASED BY 33% FOR WIND UPLIFT.
6. SHEAR DIAPHRAGM VALUE = 210#/L.F. NOMINAL

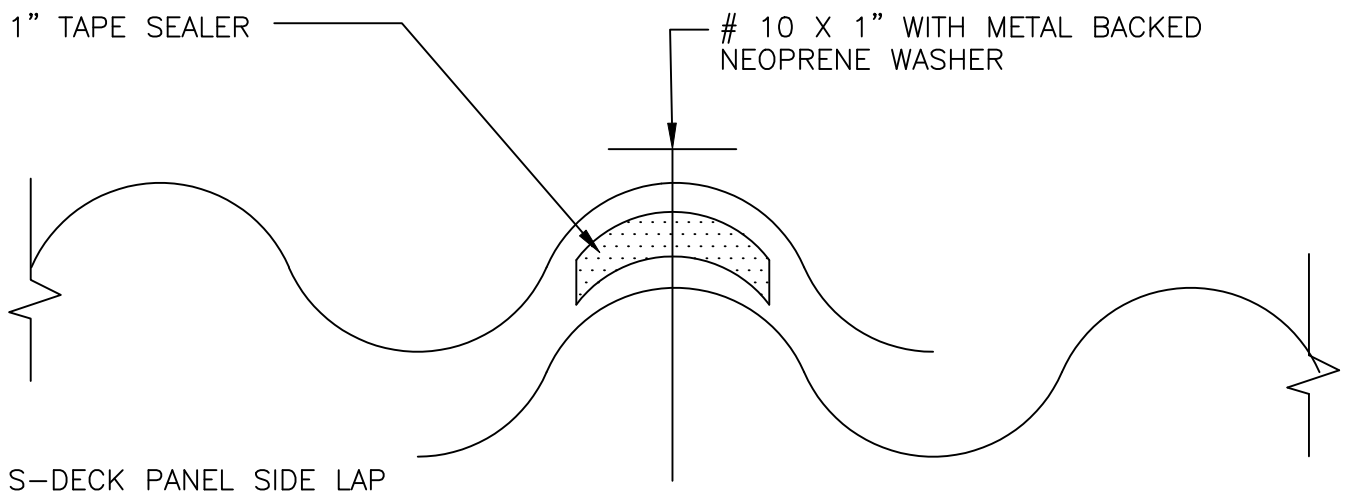

**Berridge  
Manufacturing  
Company**

OVERVIEW  
S-DECK

**S-DECK SYSTEM**

DATE: 05/14/09

PAGE\FILE  
**SD-3**



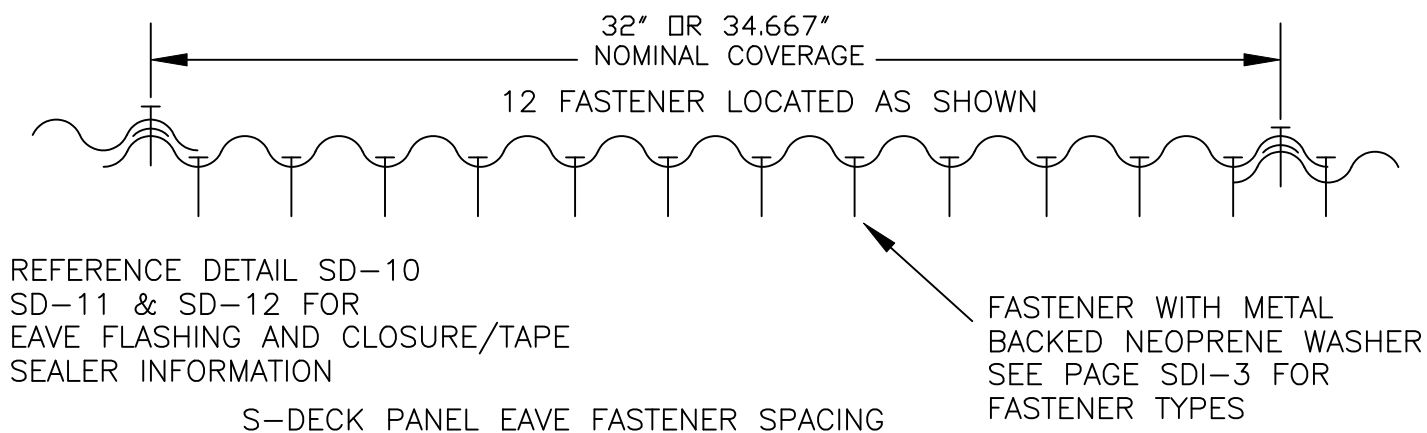
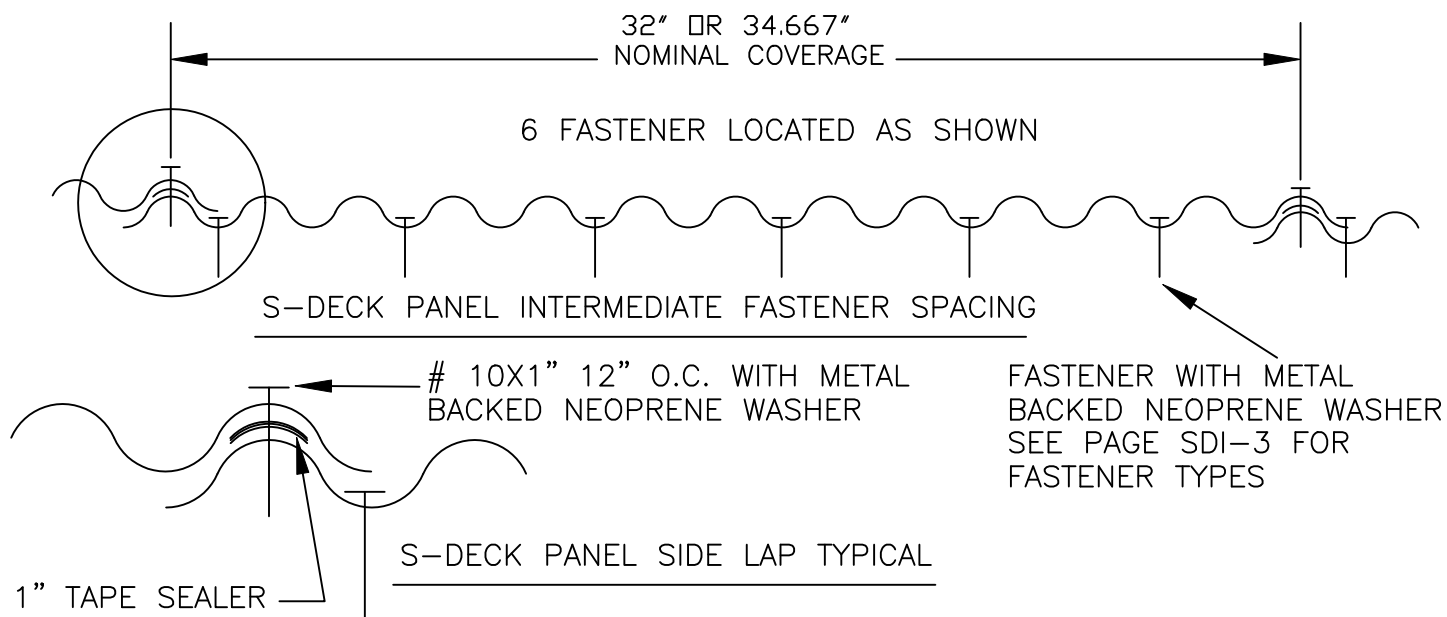
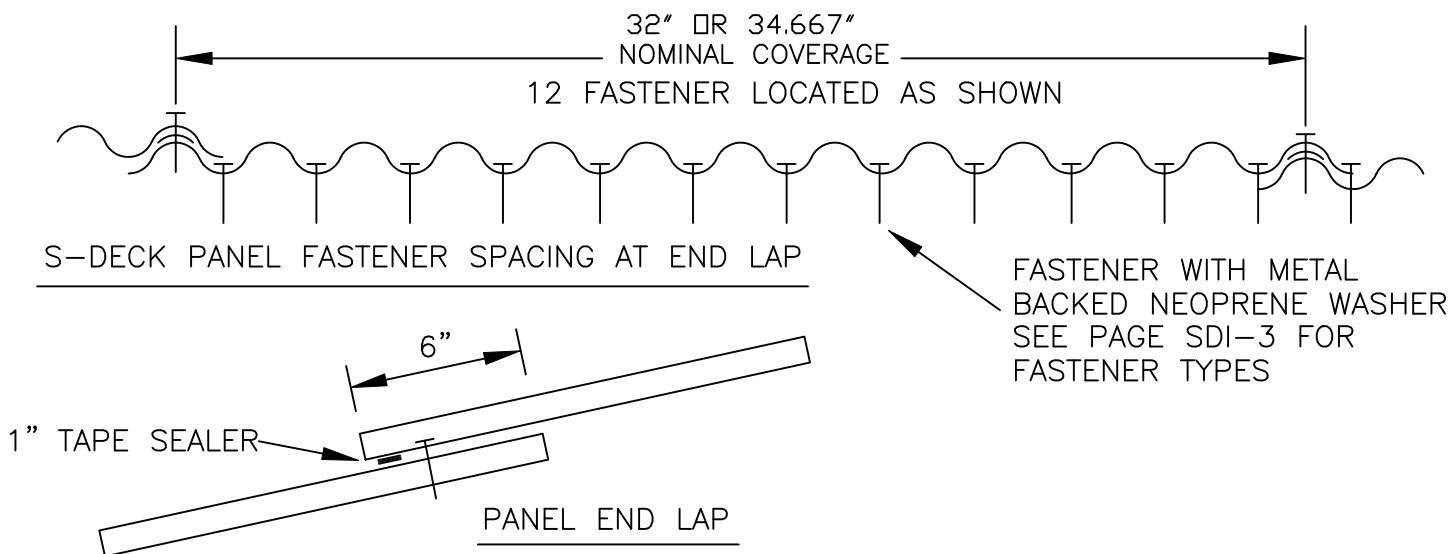

DATE: 05/14/09

FASTENER LAYOUT

PAGE\FILE

SD-4

S-DECK SYSTEM



Berridge  
Manufacturing  
Company

Roofs of Distinction

BERRIDGE S-DECK PANEL

INSIDE FOAM CLOSURE WITH TAPE  
SEALER TOP & BOTTOM

PANEL FASTENER WITH METAL  
BACKED NEOPRENE WASHER  
AT 5 1/2" O.C.

EAVE FLASHING, 4" END LAPS WITH  
CONTINUOUS CAULK AT LAPS

# 30 FELT  
UNDERLAYMENT

FASTENERS,  
20" O.C. MAX.

SOLID SHEATHING

1. SOLID SHEATHING (BY OTHERS) TO BE MINIMUM 1/2" PLYWOOD OR EQUIVALENT IN STRENGTH FOR HOLDING POWER OF FASTENERS.
2. ALL FELT UNDERLAYMENT, CAULKING AND FASTENERS ARE ITEMS TO BE FURNISHED AND INSTALLED BY THE ROOFING INSTALLER AT THE DISCRETION OF THE ARCHITECT.
3. USE ICE AND WATERSHIELD AS UNDERLAYMENT FOR CURVED S-DECK.

F = FINISH SIDE

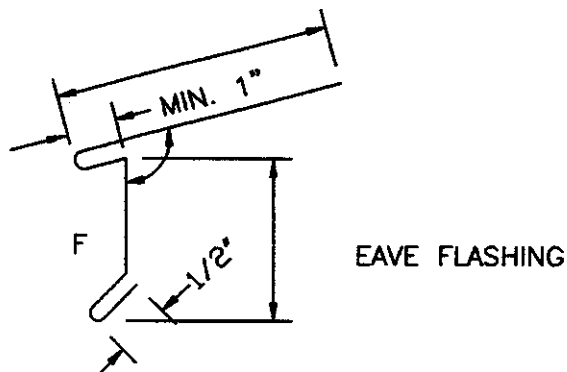

**Berridge  
Manufacturing  
Company**

EAVE DETAIL  
SOLID SHEATHING

**S-DECK SYSTEM**

DATE: 11/20/00

PAGE\FILE  
SD-10

BERRIDGE S-DECK PANEL

INSIDE FOAM CLOSURE WITH TAPE  
SEALER TOP & BOTTOM

PANEL FASTENER WITH METAL  
BACKED NEOPRENE WASHER  
AT 5 1/2" O.C.

EAVE FLASHING, 4" END LAPS WITH  
CONTINUOUS CAULK AT LAPS

BERRIDGE WALL PANEL

FASTENERS,  
20" O.C. MAX.

PURLIN

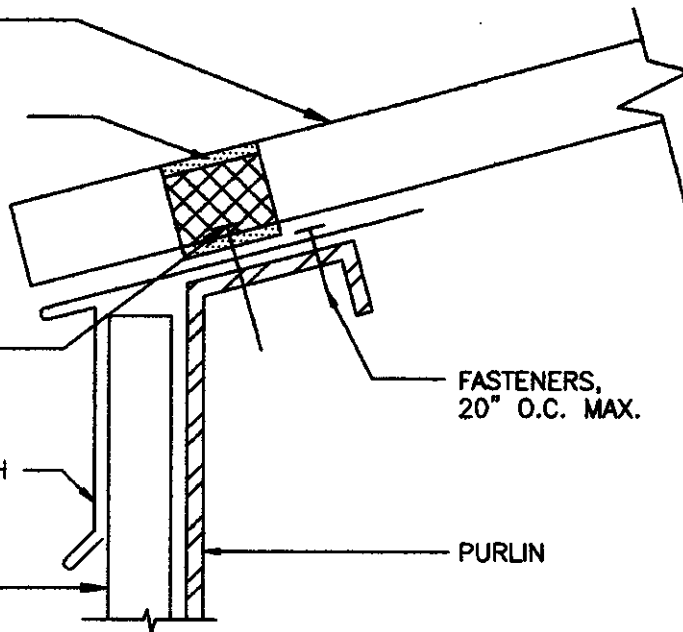

1. CAULKING AND FASTENERS ARE ITEMS TO BE FURNISHED AND INSTALLED  
BY THE ROOFING INSTALLER AT THE DISCRETION OF THE ARCHITECT.

F = FINISH SIDE

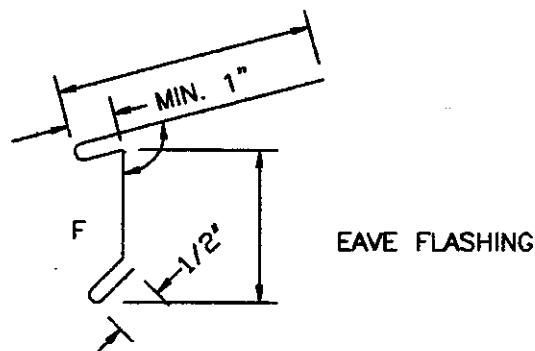

DATE: 11/20/00

EAVE DETAIL  
OPEN FRAMING

PAGE \ FILE  
SD-II

**S-DECK SYSTEM**



**Berridge  
Manufacturing  
Company**

BERRIDGE S-DECK PANEL

INSIDE FOAM CLOSURE  
WITH TAPE SEALER  
TOP AND BOTTOM

PANEL FASTENER WITH METAL  
BACKED NEOPRENE WASHER  
AT 5 1/2" O.C.

OUTSIDE FOAM CLOSURE  
WITH TAPE SEALER  
TOP AND BOTTOM

FASTENER WITH METAL  
BACKED NEOPRENE WASHER  
20" O.C.

EAVE FLASHING, 4" END  
LAPS WITH CONTINUOUS  
CAULK AT LAPS

# 30 FELT  
UNDERLAYMENT

FASTENERS,  
20" O.C. MAX.

SOLID SHEATHING

BERRIDGE S-DECK PANEL

1. SOLID SHEATHING (BY OTHERS) TO BE MINIMUM 1/2" PLYWOOD OR EQUIVALENT IN STRENGTH FOR HOLDING POWER OF FASTENERS.
2. ALL FELT UNDERLAYMENT, CAULKING AND FASTENERS ARE ITEMS TO BE FURNISHED AND INSTALLED BY THE ROOFING INSTALLER AT THE DISCRETION OF THE ARCHITECT.
3. USE ICE AND WATERSHIELD AS UNDERLAYMENT FOR CURVED S-DECK.

F = FINISH SIDE

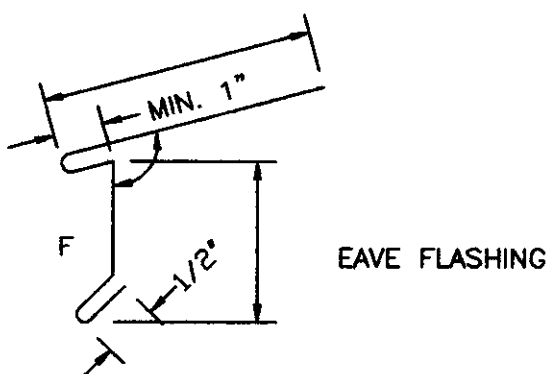

**Berridge  
Manufacturing  
Company**

EAVE DETAIL  
SOLID SHEATHING

**S-DECK SYSTEM**

DATE: 11/20/00

PAGE \ FILE  
**SD-12**

RIDGE/HIP CAP; 4" END LAPS WITH  
CONTINUOUS CAULK AT LAPS.  
POP RIVET AT LAPS

BERRIDGE S-DECK PANEL

PANEL FASTENER WITH  
METAL BACKED NEOPRENE  
WASHER

FASTENERS WITH METAL  
BACKED NEOPRENE  
WASHER 20" O.C.

OUTSIDE FOAM CLOSURE  
WITH TAPE SEALER  
TOP AND BOTTOM.  
USE 1" EXPANDABLE  
FOAM CLOSURE  
WITH TAPE SEALER  
TOP AND BOTTOM  
AT HIPS

# 30 FELT UNDERLAYMENT  
SOLID SHEATHING

1. SOLID SHEATHING (BY OTHERS) TO BE MINIMUM 1/2" PLYWOOD OR EQUIVALENT IN STRENGTH FOR HOLDING POWER OF FASTENERS.
2. ALL FELTING UNDERLAYMENT, CAULKING, AND FASTENERS, ARE ITEMS TO BE FURNISHED AND INSTALLED BY THE ROOFING INSTALLER AT THE DISCRETION OF THE ARCHITECT.

F = FINISH SIDE

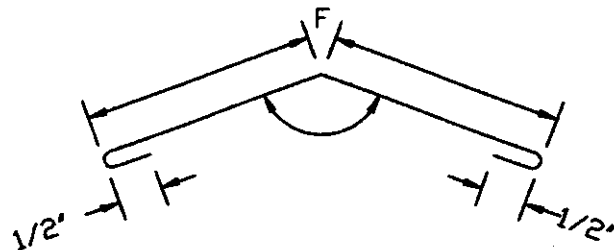

RIDGE/HIP CAP



**Berridge  
Manufacturing  
Company**

RIDGE AND HIP DETAIL

**S-DECK SYSTEM**

DATE: 11/20/00

PAGE\FILE  
**SD-20**

RIDGE CAP; 4" END LAPS WITH  
CONTINUOUS CAULK AT LAPS.  
POP RIVET AT LAPS

BERRIDGE S-DECK PANEL

FASTENERS WITH METAL  
BACKED NEOPRENE  
WASHER 20" O.C.

OUTSIDE FOAM CLOSURE  
WITH TAPE SEALER  
TOP AND BOTTOM

PANEL FASTENER WITH  
METAL BACKED NEOPRENE  
WASHER

FASTENER WITH  
METAL BACKED NEOPRENE  
WASHER. 40" O.C. MAX

# 30 FELT UNDERLAYMENT  
LAP FELT OVER RIDGE

SOLID SHEATHING

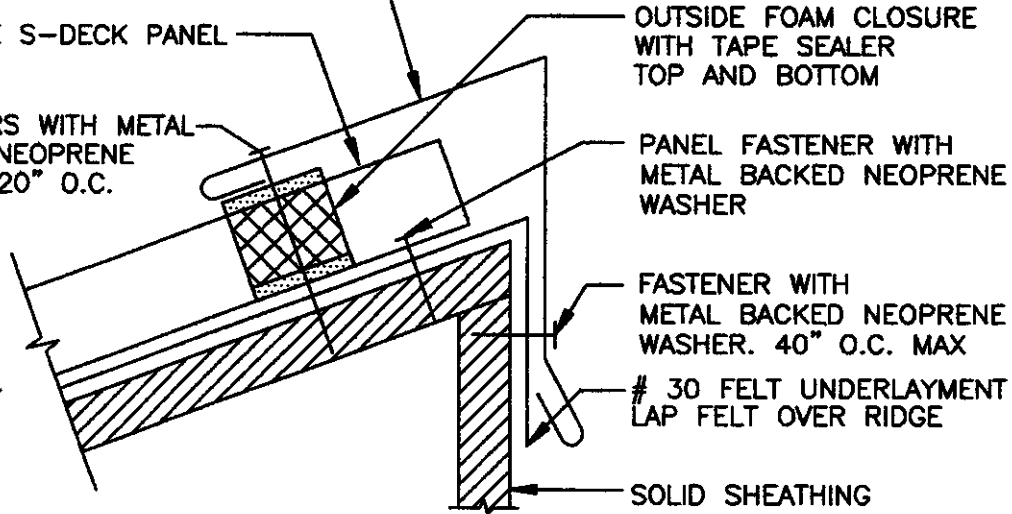

1. SOLID SHEATHING (BY OTHERS) TO BE MINIMUM 1/2" PLYWOOD OR EQUIVALENT IN STRENGTH FOR HOLDING POWER OF FASTENERS.
2. ALL FELTING UNDERLAYMENT, CAULKING, AND FASTENERS, ARE ITEMS TO BE FURNISHED AND INSTALLED BY THE ROOFING INSTALLER AT THE DISCRETION OF THE ARCHITECT.

F = FINISH SIDE

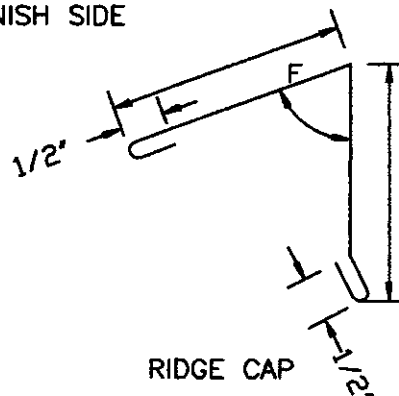

RIDGE CAP

DATE: 11/20/00

SHED ROOF RIDGE  
CAP DETAIL

PAGE\FILE  
SD-21

**S-DECK SYSTEM**



**Berridge  
Manufacturing  
Company**

*Roofs of Distinction*

RIDGE/HIP CAP; 4" END LAPS WITH  
CONTINUOUS CAULK AT LAPS.

BERRIDGE S-DECK PANEL

OUTSIDE FOAM CLOSURE  
WITH TAPE SEALER  
TOP AND BOTTOM.  
USE 1" EXPANDABLE  
FOAM CLOSURE  
WITH TAPE SEALER  
TOP AND BOTTOM  
AT HIPS

PANEL FASTENER WITH  
METAL BACKED NEOPRENE  
WASHER

FASTENERS WITH METAL  
BACKED NEOPRENE  
WASHER 20" O.C.

SUB FLASHING 4" END  
LAPS WITH CONTINUOUS  
CAULK AT LAPS

PURLINS

1. ALL CAULKING, AND FASTENERS, ARE ITEMS TO BE FURNISHED  
AND INSTALLED BY THE ROOFING INSTALLER AT THE DISCRETION OF THE ARCHITECT.

F = FINISH SIDE

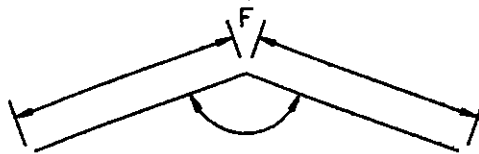

SUB FLASHING

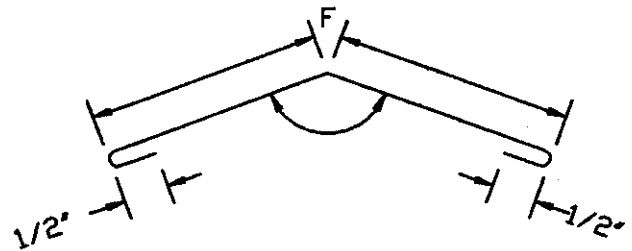

RIDGE/HIP CAP



**Berridge  
Manufacturing  
Company**

*Roofs of Distinction*

RIDGE AND HIP DETAIL  
OPEN FRAMING

**S-DECK SYSTEM**

DATE: 11/20/00

PAGE\FILE

**SD-22**

## SECTION VIEW

FIELD FORM END OF RIDGE FLASHING  
AND EXTEND UNDER UPPER PANEL

RIDGE FLASHING; 4" END LAPS  
WITH CONTINUOUS CAULK AT LAPS

FIELD TAPERED OUTSIDE CLOSURE

SD-20

BERRIDGE S-DECK  
PANEL

1" EXPANDABLE  
FOAM CLOSURE  
WITH TAPE SEALER  
TOP AND BOTTOM

# 30 FELT  
UNDERLAYMENT

PANEL FASTENER WITH  
METAL BACKED  
NEOPRENE WASHER  
AT 5 1/2" O.C.

SOLID SHEATHING

VALLEY FLASHING; 12" LAPS WITH  
CONTINUOUS CAULK AT LAPS

## PLAN VIEW

MAIN ROOF  
PANELS

RIDGE FLASHING

FOAM CLOSURE

VALLEY FLASHING

DORMER PANEL

DATE: 11/20/00

PAGE\FILE

SD-23

RIDGE TERMINATION  
AT DORMER VALLEY

**S-DECK SYSTEM**



**Berridge  
Manufacturing  
Company**

*Roofs of Distinction*



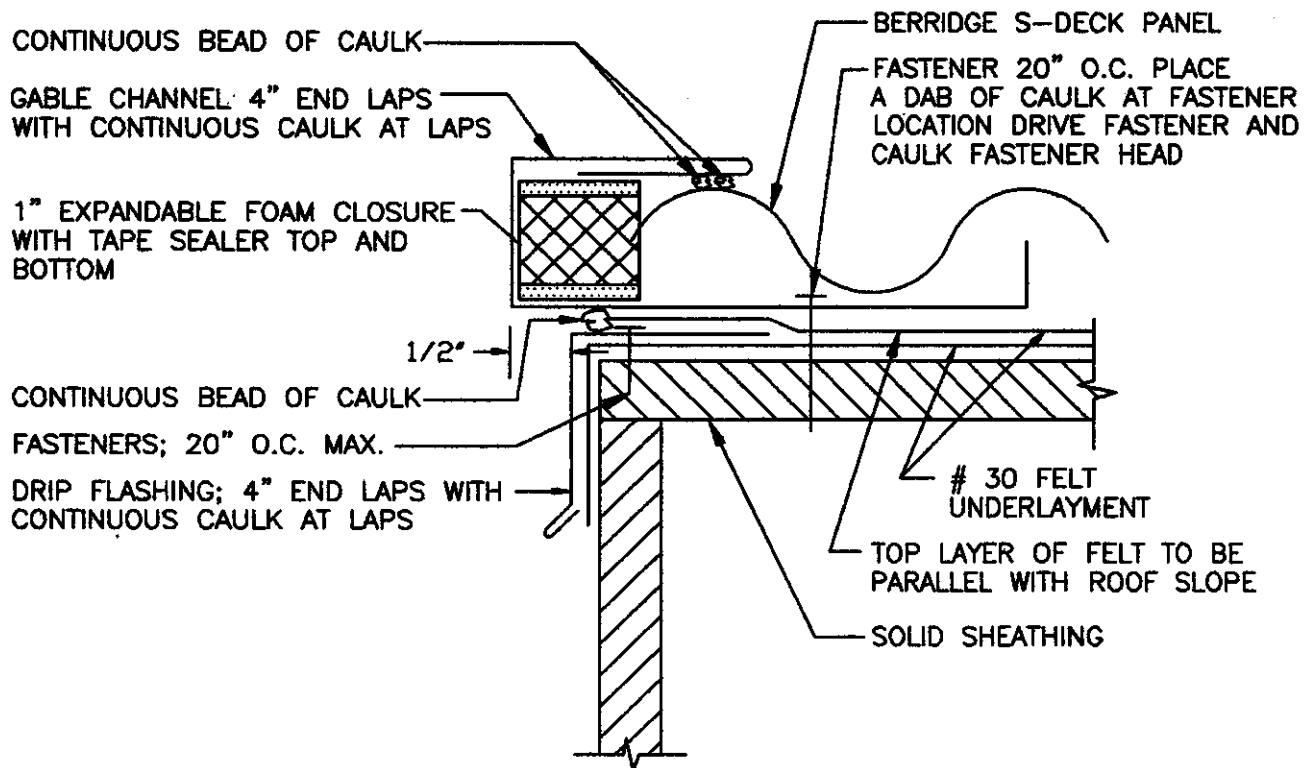

1. SOLID SHEATHING (BY OTHERS) TO BE MINIMUM 1/2" PLYWOOD OR EQUIVALENT IN STRENGTH FOR HOLDING POWER OF FASTENERS.
2. ALL FELT UNDERLAYMENT, CAULKING, AND FASTENERS, ARE ITEMS TO BE FURNISHED AND INSTALLED BY THE ROOFING INSTALLER AT THE DISCRETION OF THE ARCHITECT.

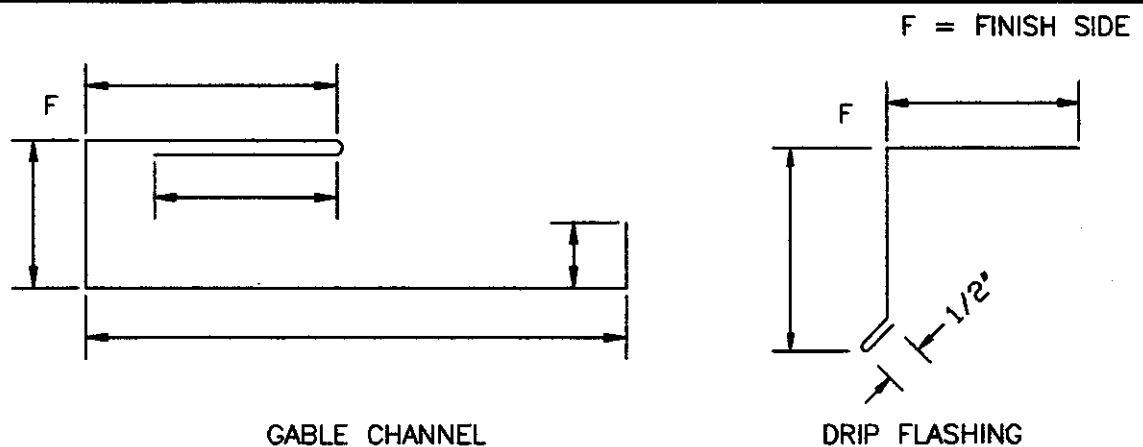

**Berridge  
Manufacturing  
Company**

GABLE DETAIL

**S-DECK SYSTEM**

DATE: 11/20/00

PAGE\FILE

**SD-30**

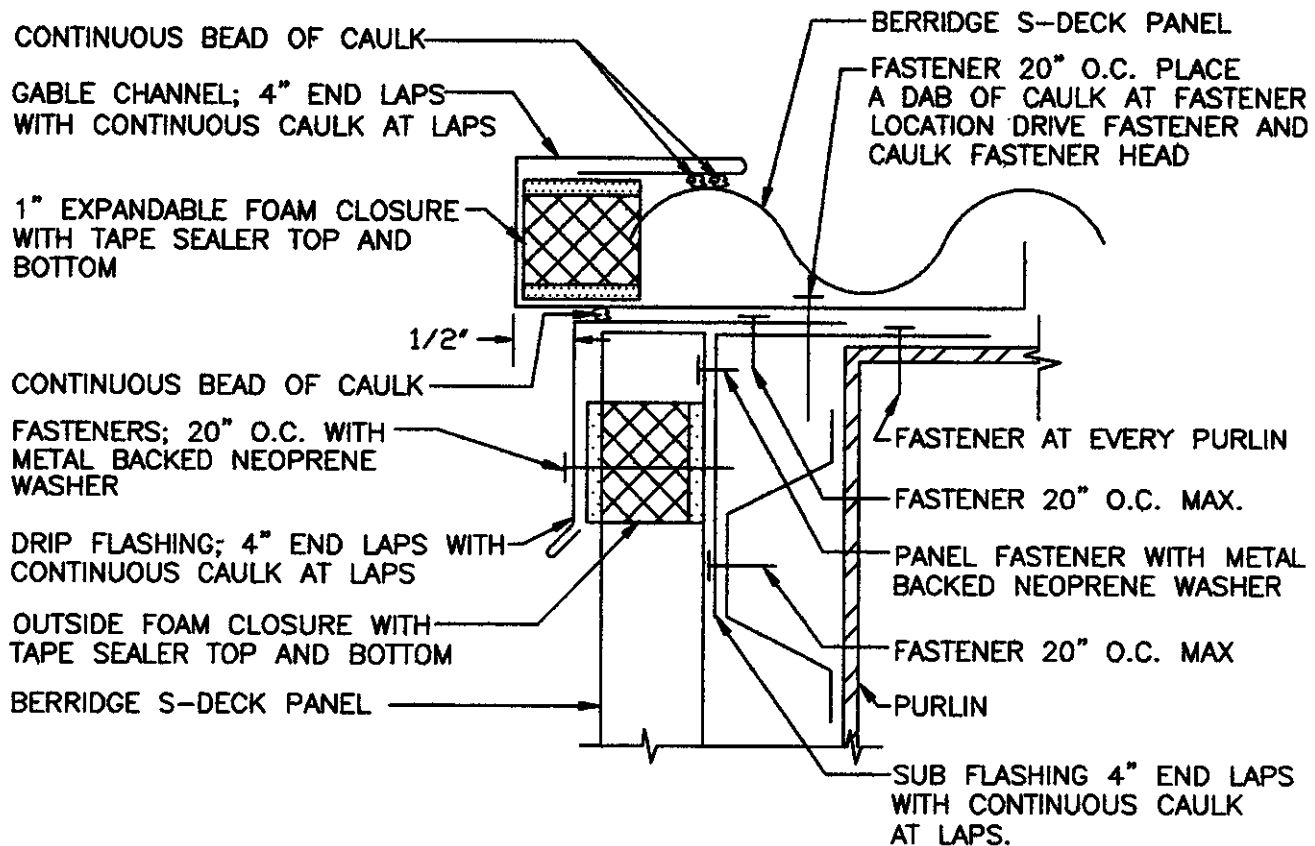

1. ALL CAULKING, AND FASTENERS, ARE ITEMS TO BE FURNISHED AND INSTALLED BY THE ROOFING INSTALLER AT THE DISCRETION OF THE ARCHITECT.

F = FINISH SIDE

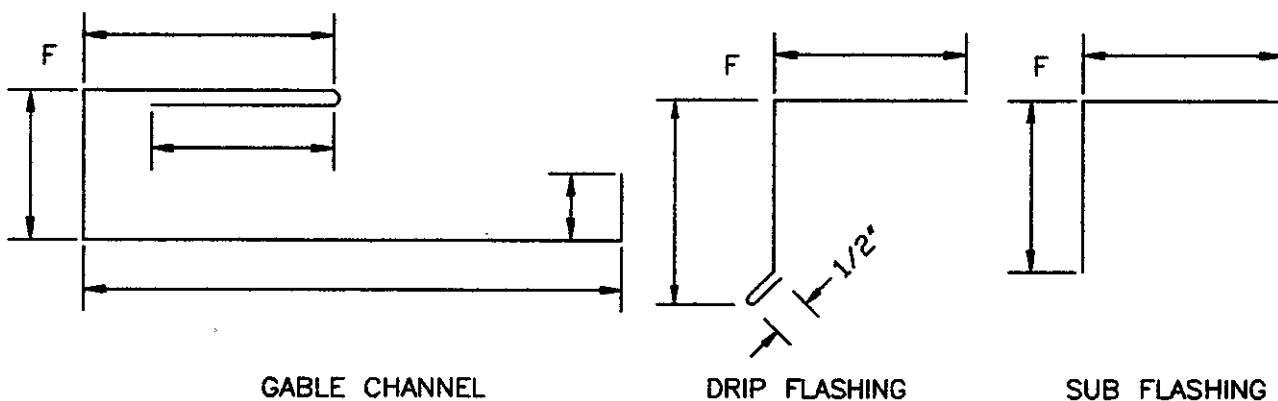

DATE: 11/20/00

GABLE DETAIL

PAGE\FILE  
SD-31

**S-DECK SYSTEM**



**Berridge  
Manufacturing  
Company**

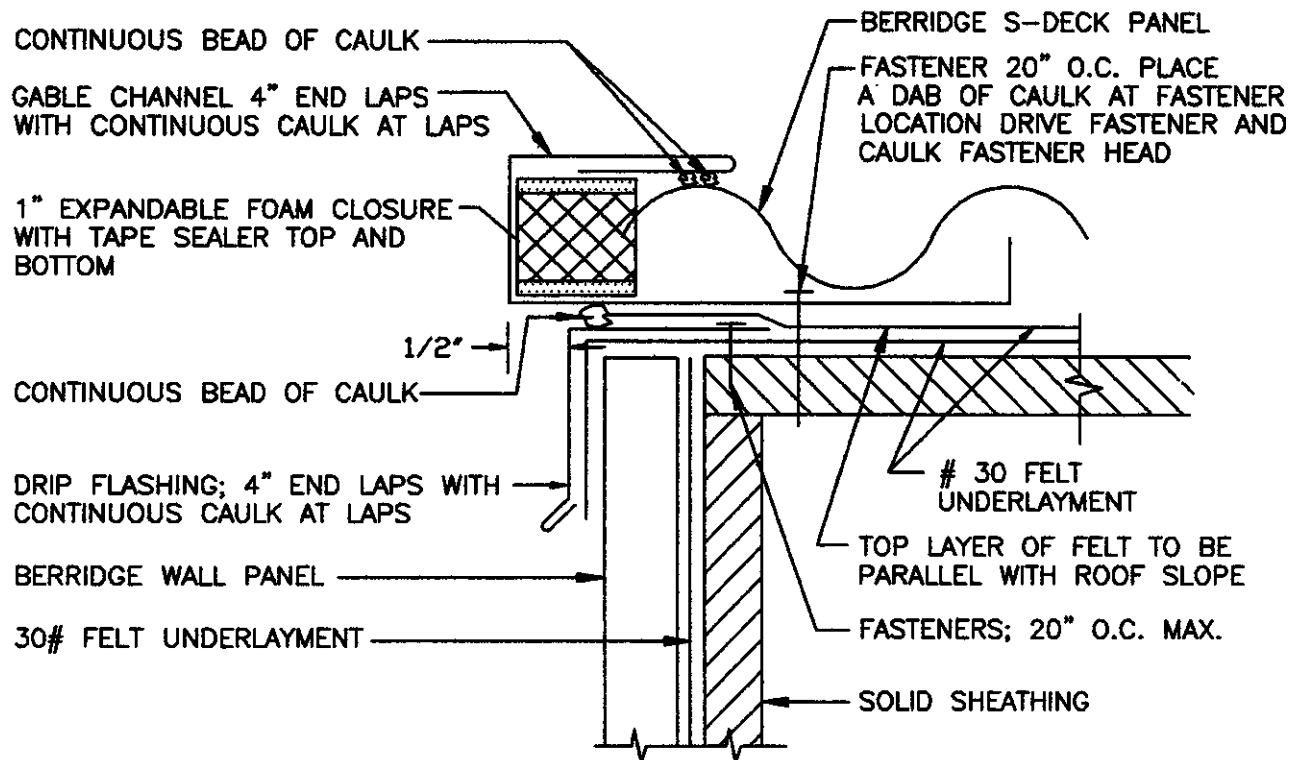

1. SOLID SHEATHING (BY OTHERS) TO BE MINIMUM 1/2" PLYWOOD OR EQUIVALENT IN STRENGTH FOR HOLDING POWER OF FASTENERS.
2. ALL FELT UNDERLAYMENT, CAULKING, AND FASTENERS, ARE ITEMS TO BE FURNISHED AND INSTALLED BY THE ROOFING INSTALLER AT THE DISCRETION OF THE ARCHITECT.

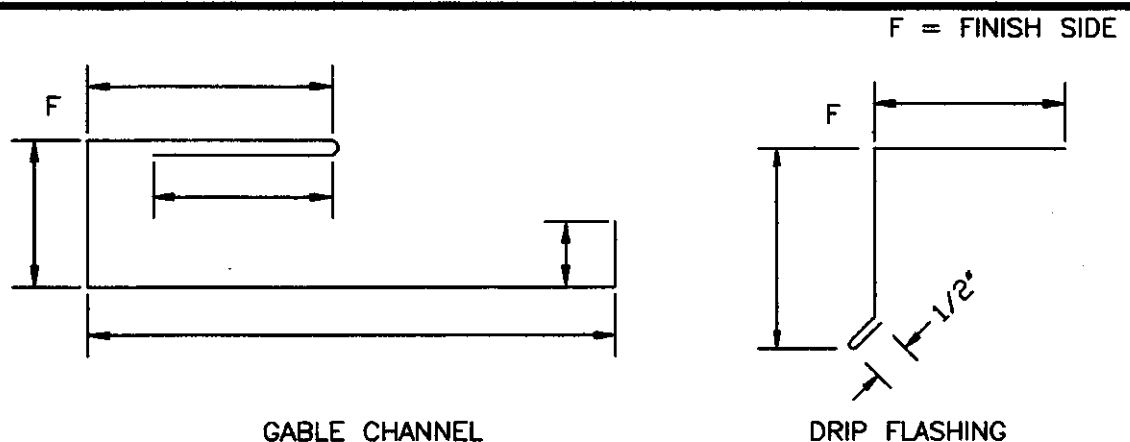

**Berridge  
Manufacturing  
Company**

GABLE DETAIL

**S-DECK SYSTEM**

DATE: 11/20/00

PAGE\FILE  
**SD-32**

FASTENERS WITH METAL BACKED  
NEOPRENE WASHER 20" O.C. MAX.

1" EXPANDABLE FOAM CLOSURE  
WITH TAPE SEALER TOP AND  
BOTTOM.

DRIP FLASHING; 4" END LAPS WITH  
CONTINUOUS CAULK AT LAPS

BERRIDGE S-DECK PANEL

CONTINUOUS BEAD OF CAULK

# 30 FELT  
UNDERLAYMENT

TOP LAYER OF FELT TO BE  
PARALLEL WITH ROOF SLOPE

FASTENERS; 20" O.C. MAX.

SOLID SHEATHING

1. SOLID SHEATHING (BY OTHERS) TO BE MINIMUM 1/2" PLYWOOD OR EQUIVALENT IN STRENGTH FOR HOLDING POWER OF FASTENERS.
2. ALL ICE AND WATERSHIELD UNDERLAYMENT, CAULKING, AND FASTENERS, ARE ITEMS TO BE FURNISHED AND INSTALLED BY THE ROOFING INSTALLER AT THE DISCRETION OF THE ARCHITECT.
3. UNDERLAYMENT TO BE ICE AND WATERSHIELD FOR CURVED PANELS.

F = FINISH SIDE

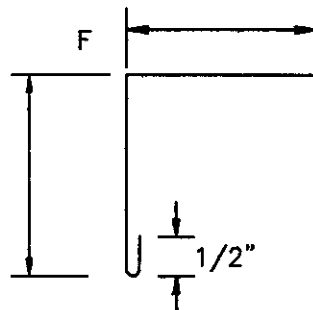

DRIP FLASHING

DATE: 11/20/00

GABLE DETAIL  
CURVED PANELS

PAGE\FILE  
SD-33

**S-DECK SYSTEM**



**Berridge  
Manufacturing  
Company**

*Roofs of Distinction*

CAP FLASHING; 4" END LAPS  
WITH CONTINUOUS CAULK AT LAPS.  
POP RIVET TO COUNTER FLASHING 40"  
O.C. MAX. CAULK ALL RIVET HEADS

FASTENERS; 20" O.C. MAX.

COUNTERFLASHING; 4" END LAPS  
WITH CONTINUOUS CAULK AT LAPS

SUB-FLASHING; 4" END LAPS WITH  
CONTINUOUS CAULK AT LAPS

# 30 FELT UNDERLAYMENT

OUTSIDE FOAM CLOSURE  
WITH TAPE SEALER  
TOP AND BOTTOM

BERRIDGE S-DECK PANEL

SOLID SHEATHING

FASTENERS AT  
LAPS AND  
STAGGERED;  
20" O.C. AND  
CAULK FASTENER  
HEADS

# 30 FELT  
UNDERLAYMENT

FASTENERS; WITH METAL  
BACKED NEOPRENE  
WASHER. 40" O.C. MAX.

PANEL FASTENERS; WITH  
METAL BACKED  
NEOPRENE WASHER

FASTENERS; WITH METAL  
BACKED NEOPRENE  
WASHER. 20" O.C. MAX.

1. SOLID SHEATHING (BY OTHERS) TO BE MINIMUM 1/2" PLYWOOD OR EQUIVALENT IN STRENGTH FOR HOLDING POWER OF FASTENERS.
2. ALL FELT UNDERLAYMENT, CAULKING, AND FASTENERS, ARE ITEMS TO BE FURNISHED AND INSTALLED BY THE ROOFING INSTALLER AT THE DISCRETION OF THE ARCHITECT.

F = FINISH SIDE

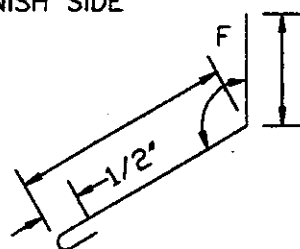

COUNTERFLASHING

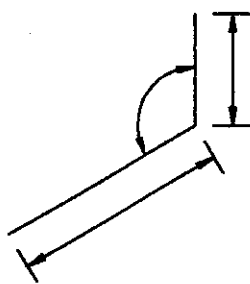

SUB-FLASHING

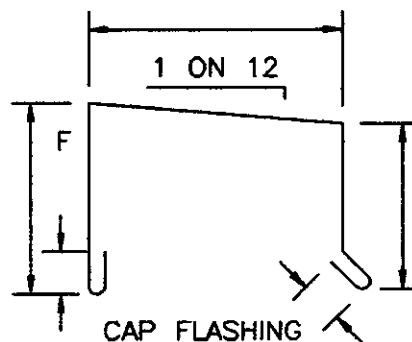

CAP FLASHING

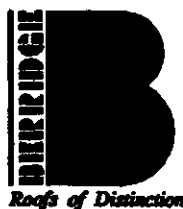

**Berridge**  
Manufacturing  
Company

PARAPET DETAIL

**S-DECK SYSTEM**

DATE: 11/20/00

PAGE\FILE  
SD-40

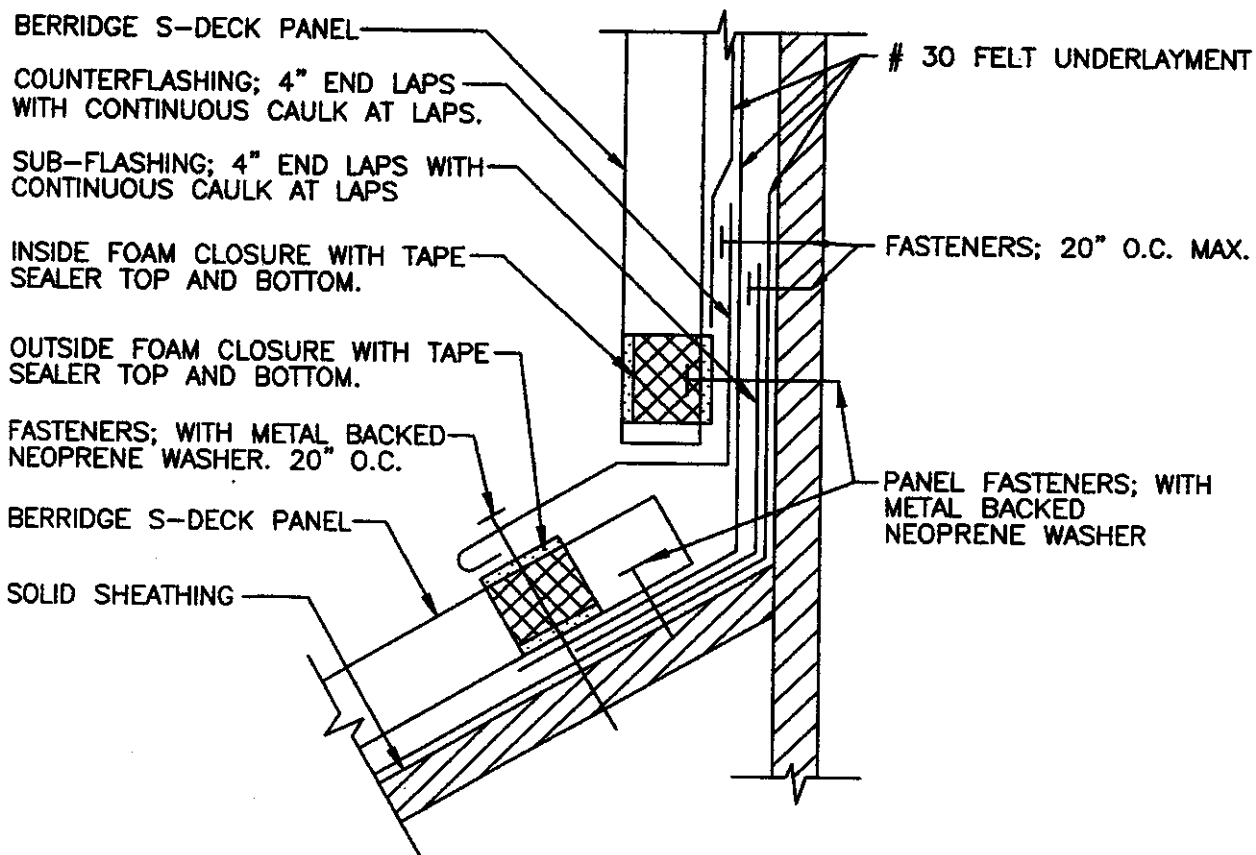

1. SOLID SHEATHING (BY OTHERS) TO BE MINIMUM 1/2" PLYWOOD OR EQUIVALENT IN STRENGTH FOR HOLDING POWER OF FASTENERS.
2. ALL FELT UNDERLAYMENT, CAULKING, AND FASTENERS, ARE ITEMS TO BE FURNISHED AND INSTALLED BY THE ROOFING INSTALLER AT THE DISCRETION OF THE ARCHITECT.

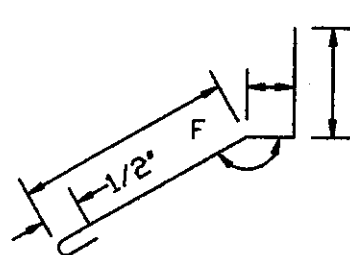

COUNTERFLASHING

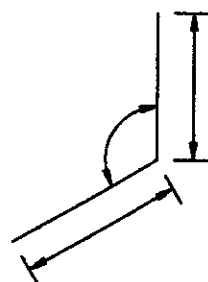

SUB-FLASHING

F = FINISH SIDE

DATE: 11/20/00

PAGE\FILE  
SD-41

HEAD WALL DETAIL

**S-DECK SYSTEM**



**Berridge  
Manufacturing  
Company**

*Roofs of Distinction*

REGLET FLASHING; 4" END LAPS  
WITH CONTINUOUS CAULK AT LAPS  
FASTENERS; 20" O.C. MAX.

COUNTERFLASHING; 4" END LAPS  
WITH CONTINUOUS CAULK AT LAPS.

SUB-FLASHING; 4" END LAPS WITH  
CONTINUOUS CAULK AT LAPS

# 30 FELT UNDERLAYMENT

BERRIDGE S-DECK PANEL

OUTSIDE FOAM CLOSURE  
WITH TAPE SEALER TOP  
AND BOTTOM.

SOLID SHEATHING

REGLET

CONTINUOUS CAULK  
AT REGLET

CONTINUOUS BEAD  
OF CAULK

PANEL FASTENERS  
WITH METAL BACKED  
NEOPRENE WASHER.

FASTENERS  
WITH METAL BACKED  
NEOPRENE WASHER.  
20" O.C.

1. SOLID SHEATHING (BY OTHERS) TO BE MINIMUM 1/2" PLYWOOD OR EQUIVALENT IN STRENGTH FOR HOLDING POWER OF FASTENERS.
2. ALL FELT UNDERLAYMENT, CAULKING, AND FASTENERS, ARE ITEMS TO BE FURNISHED AND INSTALLED BY THE ROOFING INSTALLER AT THE DISCRETION OF THE ARCHITECT.

F = FINISH SIDE

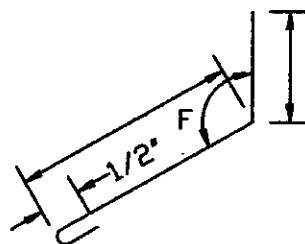

COUNTERFLASHING

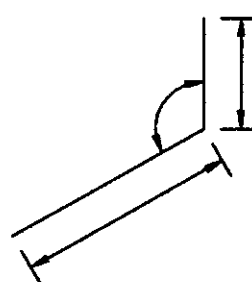

SUB-FLASHING

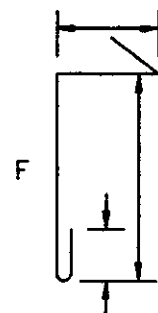

REGLET FLASHING



**Berridge  
Manufacturing  
Company**

HEAD WALL DETAIL

**S-DECK SYSTEM**

DATE: 11/20/00

PAGE\FILE  
**SD-42**

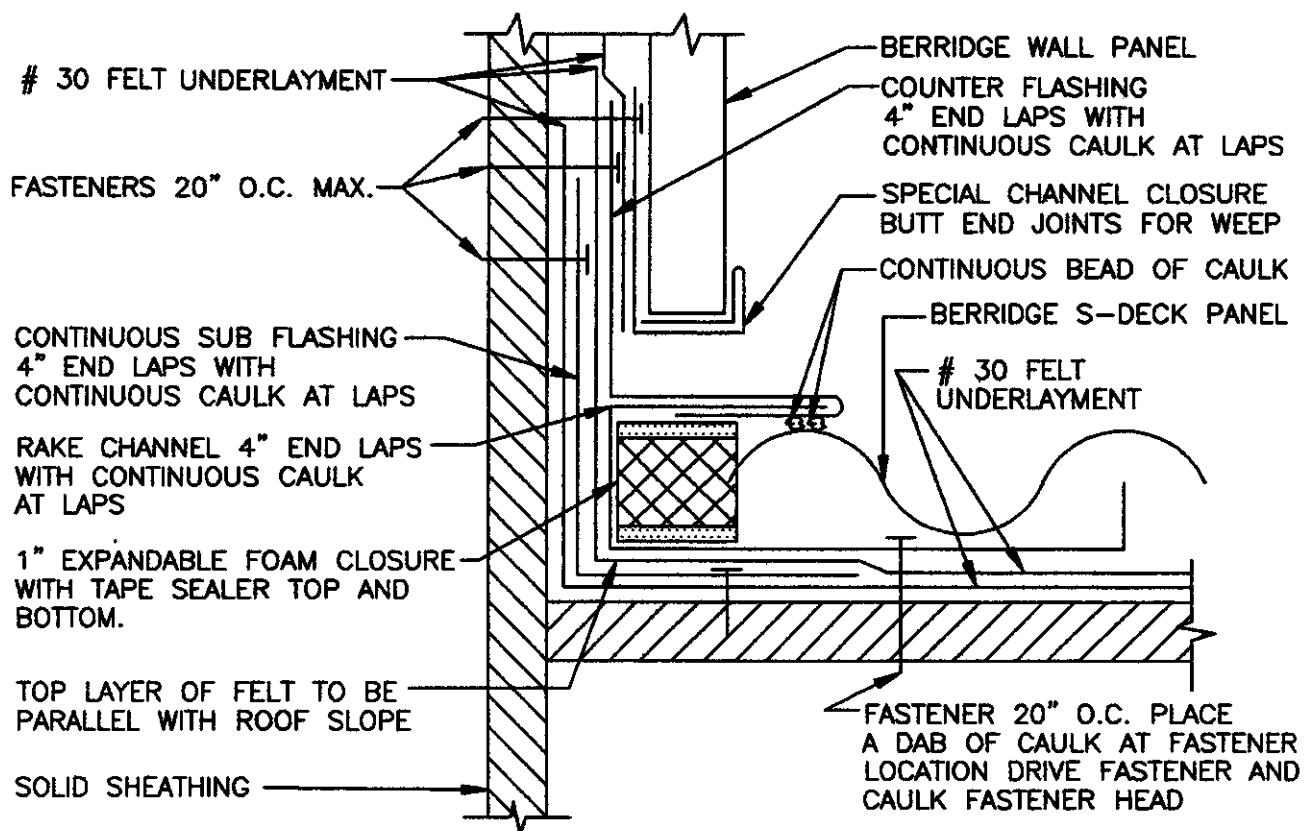

1. SOLID SHEATHING (BY OTHERS) TO BE MINIMUM 1/2" PLYWOOD OR EQUIVALENT IN STRENGTH FOR HOLDING POWER OF FASTENERS.

2. ALL FELT UNDERLAYMENT, CAULKING, AND FASTENERS, ARE ITEMS TO BE FURNISHED AND INSTALLED BY THE ROOFING INSTALLER AT THE DISCRETION OF THE ARCHITECT.

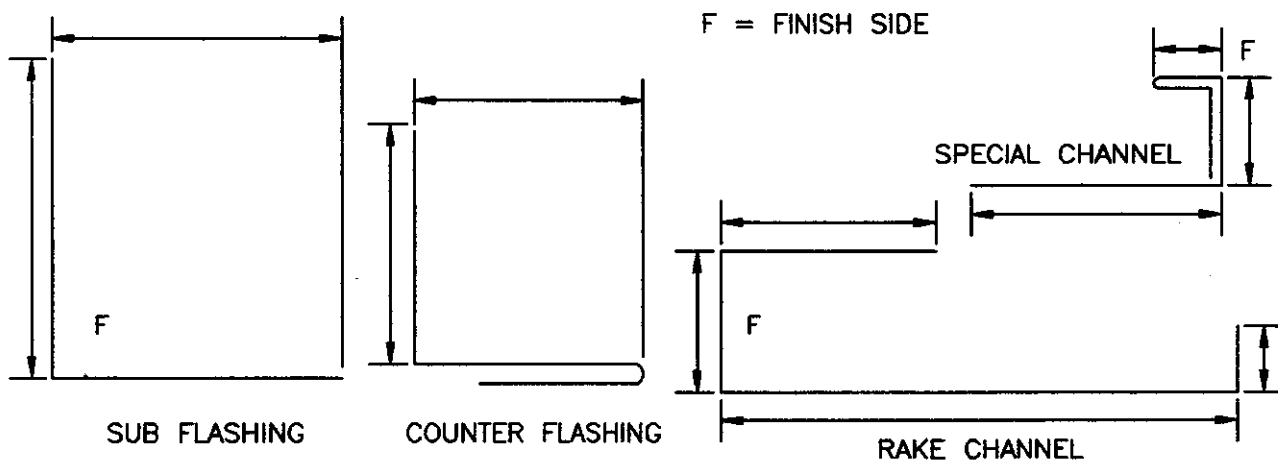

**Berridge  
Manufacturing  
Company**

RAKE WALL  
WITH WALL PANEL

**S-DECK SYSTEM**

DATE: 11/20/00

PAGE\FILE  
**SD-50**



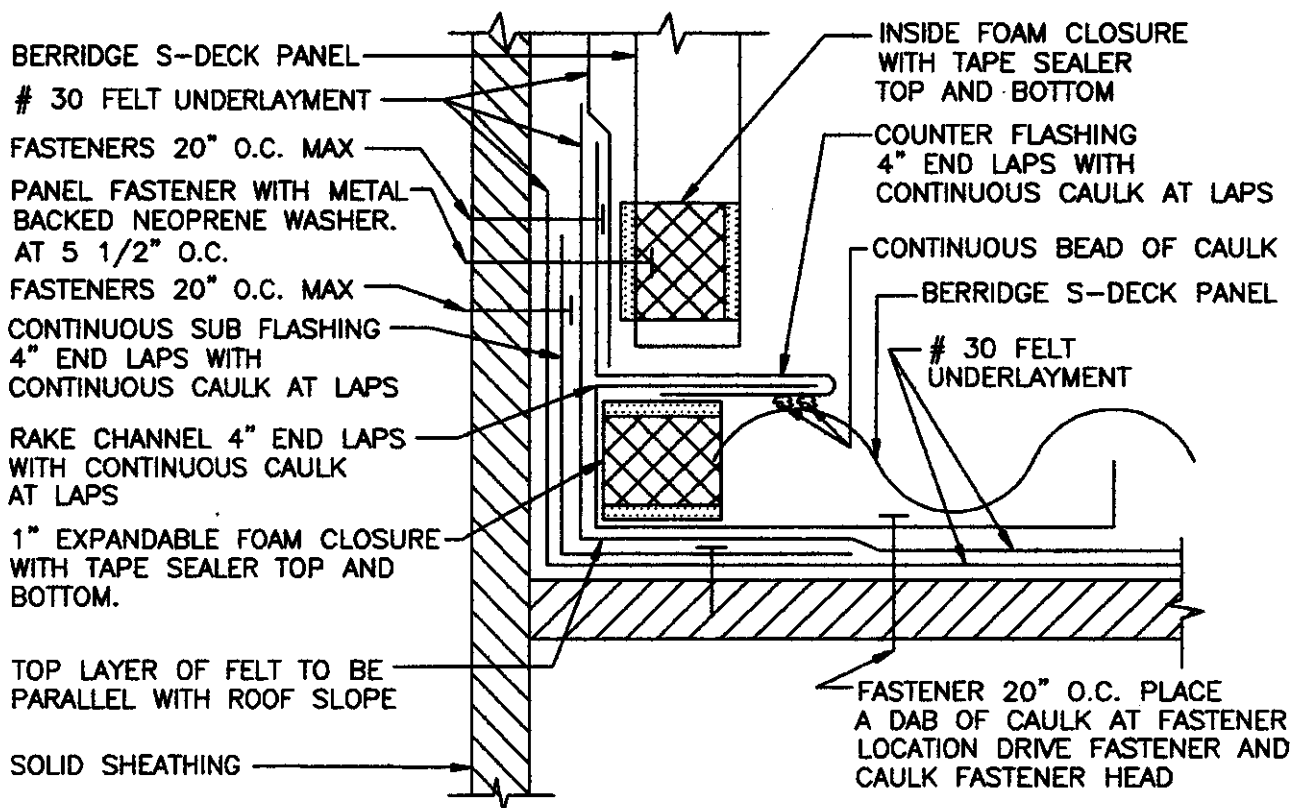

1. SOLID SHEATHING (BY OTHERS) TO BE MINIMUM 1/2" PLYWOOD OR EQUIVALENT IN STRENGTH FOR HOLDING POWER OF FASTENERS.
2. ALL FELT UNDERLAYMENT, CAULKING, AND FASTENERS, ARE ITEMS TO BE FURNISHED AND INSTALLED BY THE ROOFING INSTALLER AT THE DISCRETION OF THE ARCHITECT.

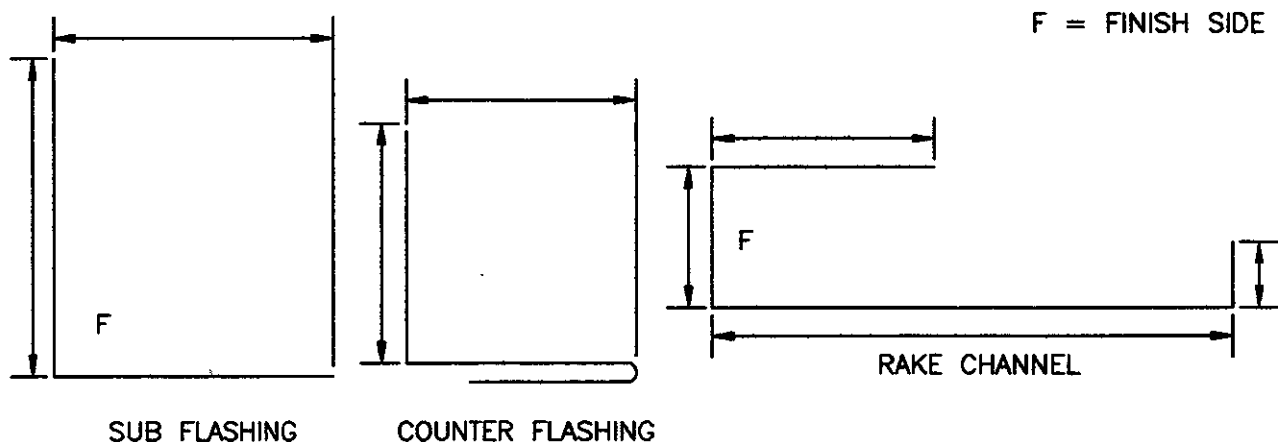

DATE: 11/20/00

PAGE\FILE  
SD-51

RAKE WALL DETAIL

**S-DECK SYSTEM**



**Berridge  
Manufacturing  
Company**

*Roofs of Distinction*

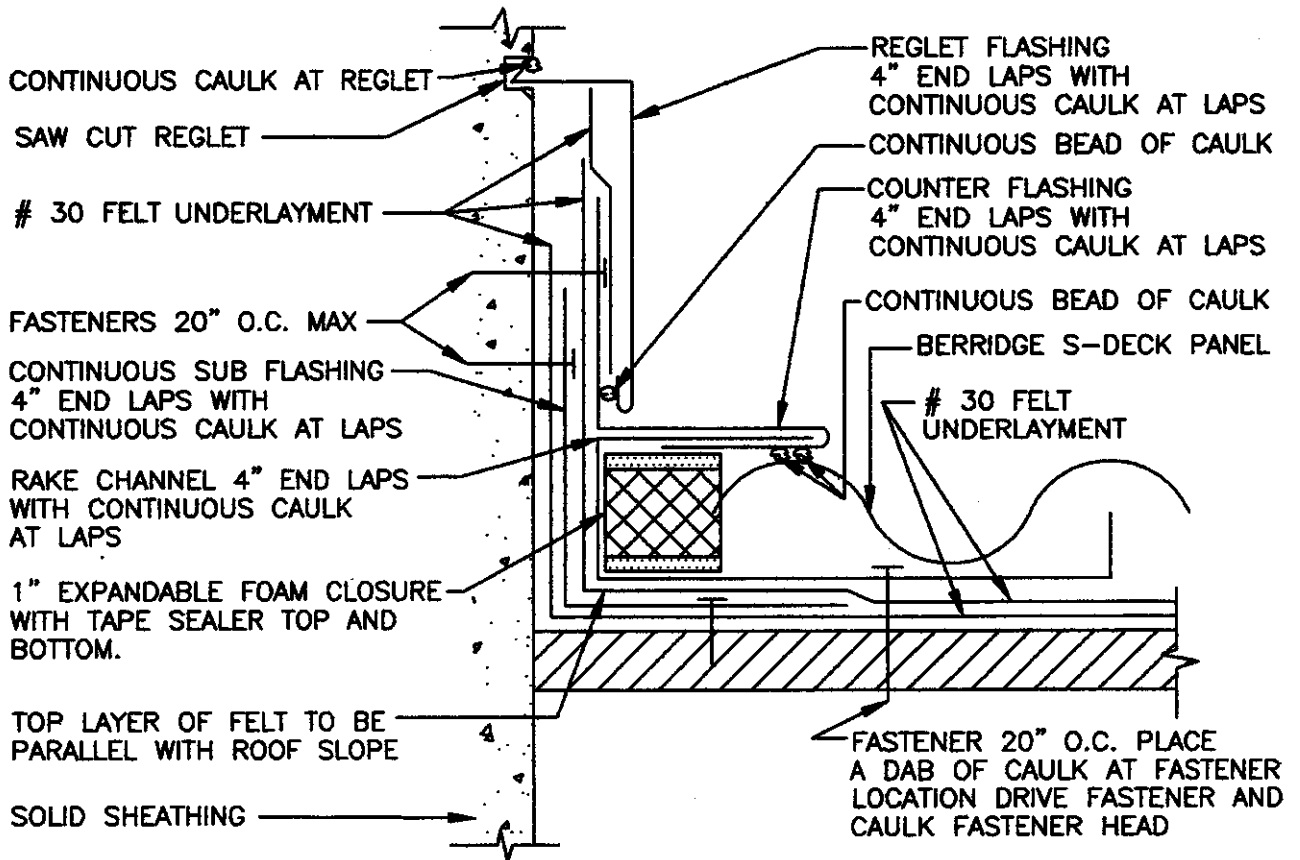

1. SOLID SHEATHING (BY OTHERS) TO BE MINIMUM 1/2" PLYWOOD OR EQUIVALENT IN STRENGTH FOR HOLDING POWER OF FASTENERS.
2. ALL FELT UNDERLAYMENT, CAULKING, AND FASTENERS, ARE ITEMS TO BE FURNISHED AND INSTALLED BY THE ROOFING INSTALLER AT THE DISCRETION OF THE ARCHITECT.

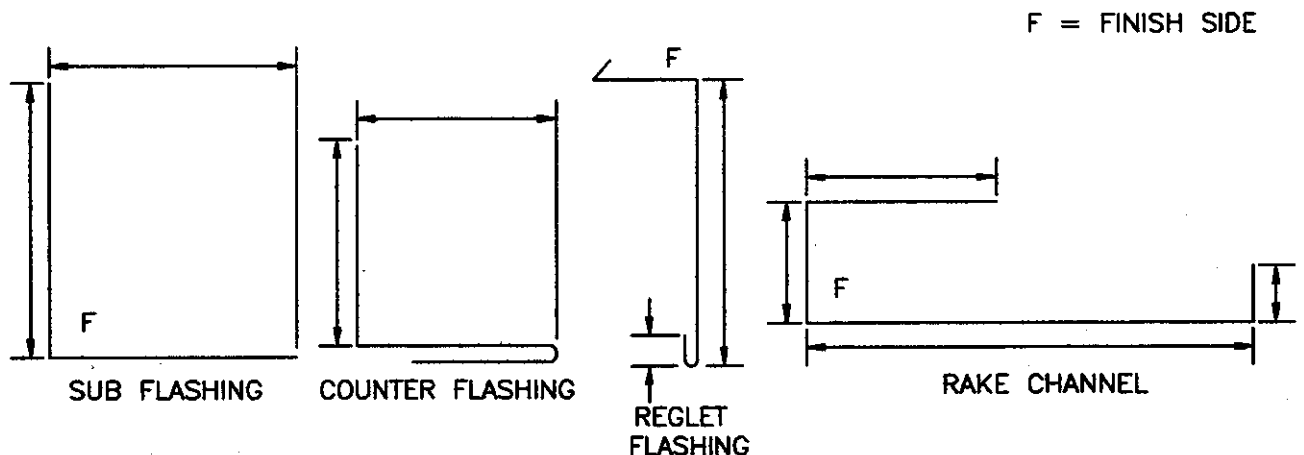

RAKE WALL DETAIL  
WITH REGLET

**S-DECK SYSTEM**

DATE: 11/20/00

PAGE\FILE

SD-52

CAP FLASHING 4" END LAPS WITH CONTINUOUS CAULK AT LAPS

1 ON 12

# 30 FELT UNDERLAYMENT

CONTINUOUS CLEAT

CONTINUOUS SUB FLASHING 4" END LAPS WITH CONTINUOUS CAULK AT LAPS

1" EXPANDABLE FOAM CLOSURE WITH TAPE SEALER TOP AND BOTTOM.

TOP LAYER OF FELT TO BE PARALLEL WITH ROOF SLOPE

SOLID SHEATHING

RAKE CHANNEL 4" END LAPS WITH CONTINUOUS CAULK AT LAPS

FASTENERS 20" O.C. MAX.

CONTINUOUS CLEAT

COUNTER FLASHING 4" END LAPS WITH CONTINUOUS CAULK AT LAPS

CONTINUOUS BEAD OF CAULK

BERRIDGE S-DECK PANEL

# 30 FELT UNDERLAYMENT

FASTENER 20" O.C. PLACE A DAB OF CAULK AT FASTENER LOCATION DRIVE FASTENER AND CAULK FASTENER HEAD

1. SOLID SHEATHING (BY OTHERS) TO BE MINIMUM 1/2" PLYWOOD OR EQUIVALENT IN STRENGTH FOR HOLDING POWER OF FASTENERS.

2. ALL FELT UNDERLAYMENT, CAULKING, AND FASTENERS, ARE ITEMS TO BE FURNISHED AND INSTALLED BY THE ROOFING INSTALLER AT THE DISCRETION OF THE ARCHITECT.

F = FINISH SIDE

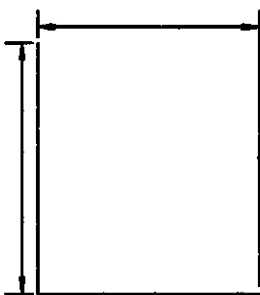

SUB FLASHING

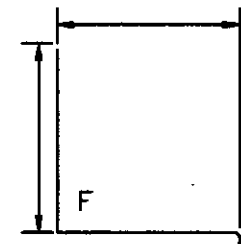

COUNTER FLASHING

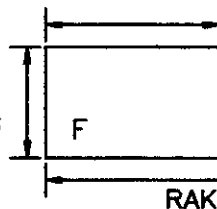

RAKE CHANNEL

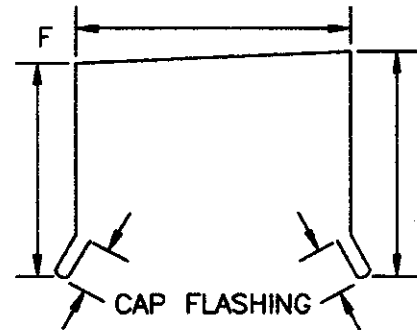

CAP FLASHING

DATE: 11/20/00

PAGE\FILE  
SD-53

RAKE WALL  
PARAPET WALL

**S-DECK SYSTEM**



**Berridge  
Manufacturing  
Company**

*Roofs of Distinction*

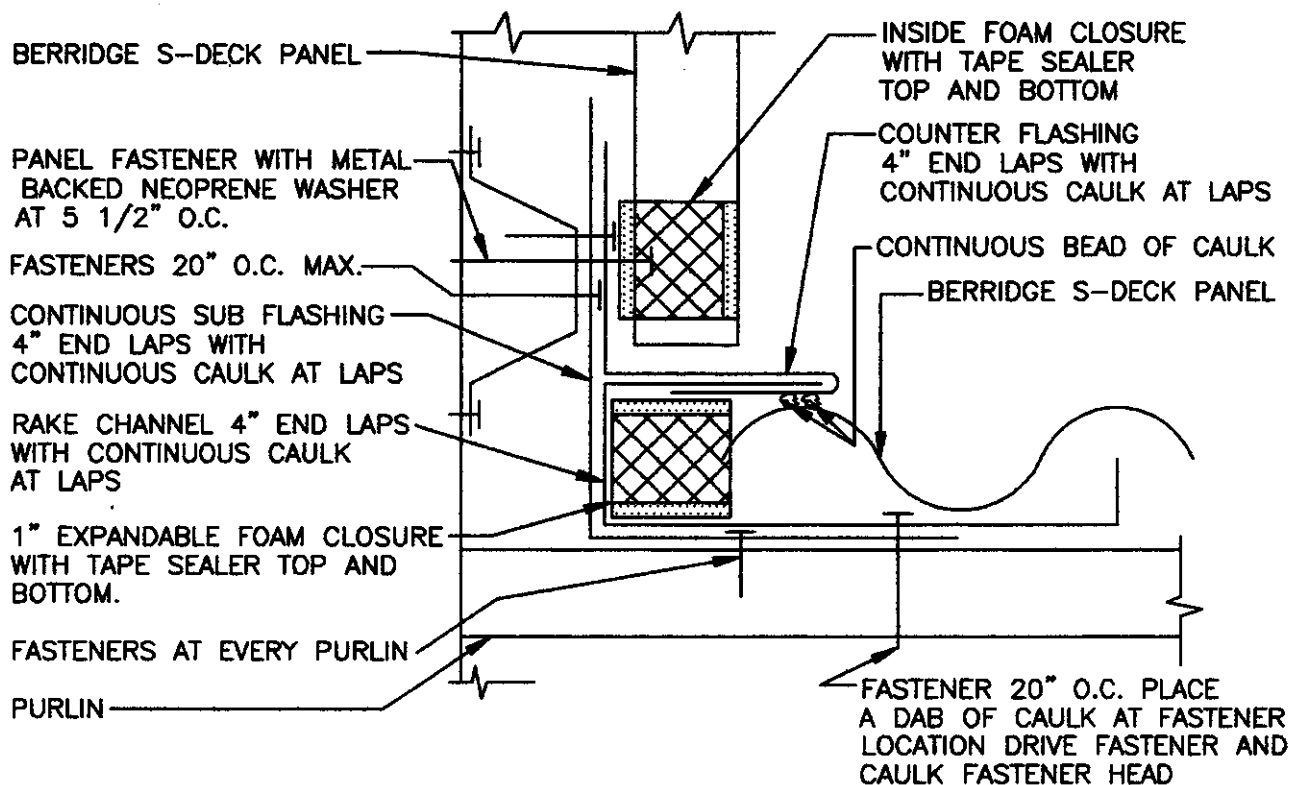

1. ALL CAULKING, AND FASTENERS, ARE ITEMS TO BE FURNISHED AND INSTALLED BY THE ROOFING INSTALLER AT THE DISCRETION OF THE ARCHITECT.

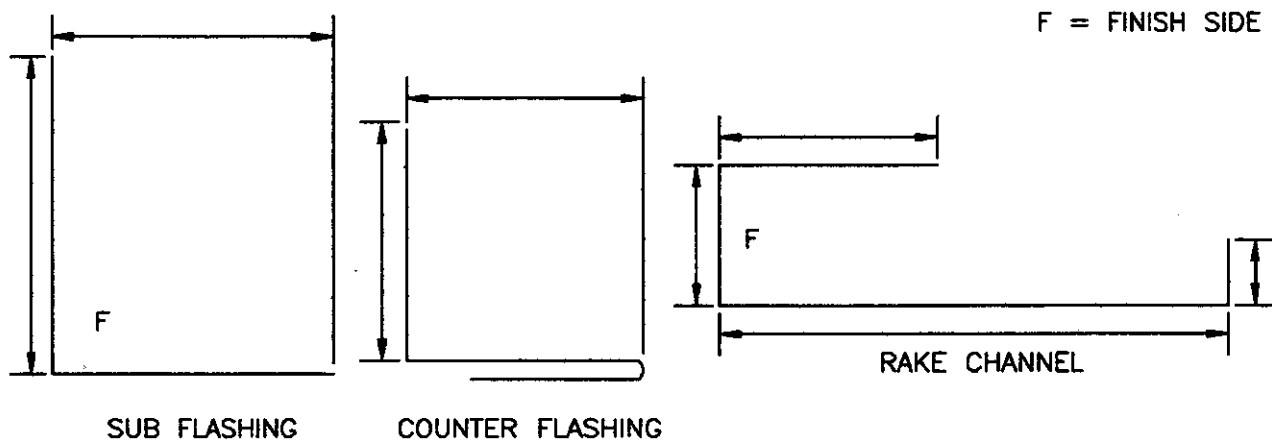

**Berridge Manufacturing Company**

**RAKE WALL DETAIL  
OPEN FRAMING**

**S-DECK SYSTEM**

DATE: 11/20/00

PAGE\FILE

**SD-54**

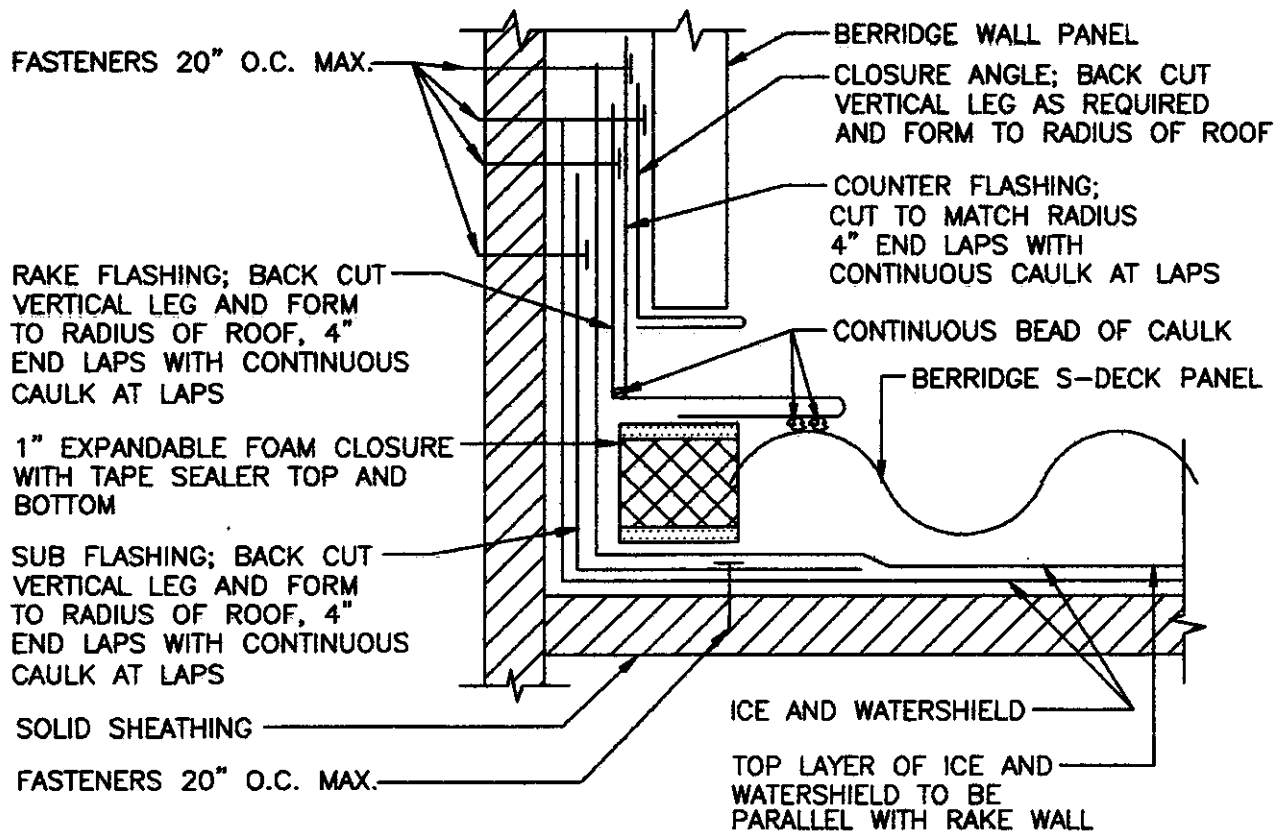

1. SOLID SHEATHING (BY OTHERS) TO BE MINIMUM 1/2" PLYWOOD OR EQUIVALENT IN STRENGTH FOR HOLDING POWER OF FASTENERS.
2. ALL ICE AND WATERSHIELD UNDERLAYMENT, CAULKING, AND FASTENERS, ARE ITEMS TO BE FURNISHED AND INSTALLED BY THE ROOFING INSTALLER AT THE DISCRETION OF THE ARCHITECT.
3. UNDERLAYMENT TO BE ICE AND WATERSHIELD FOR CURVED PANELS.

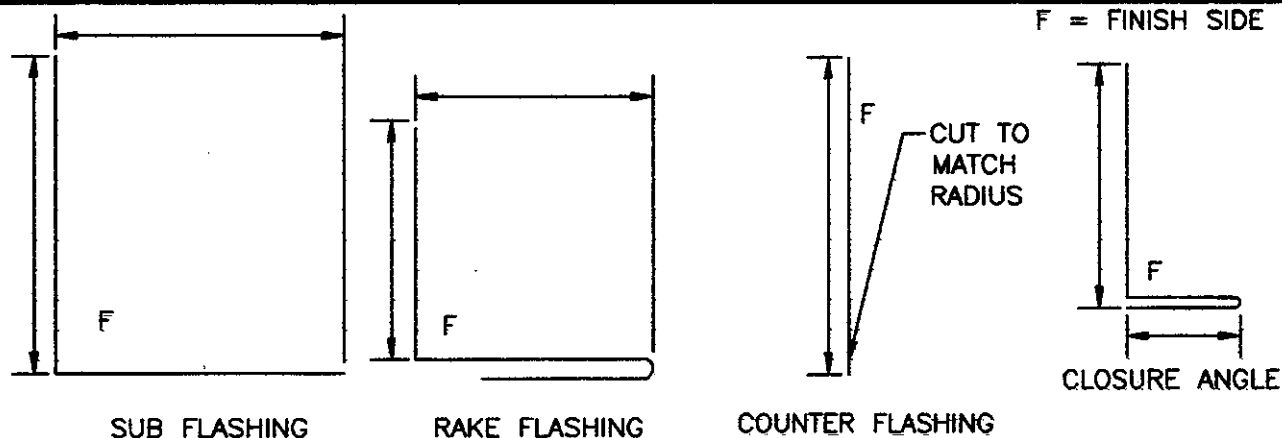

DATE: 11/20/00

PAGE\FILE  
SD-55

RAKE WALL  
CURVED PANELS

**S-DECK SYSTEM**



**Berridge  
Manufacturing  
Company**

*Roofs of Distinction*

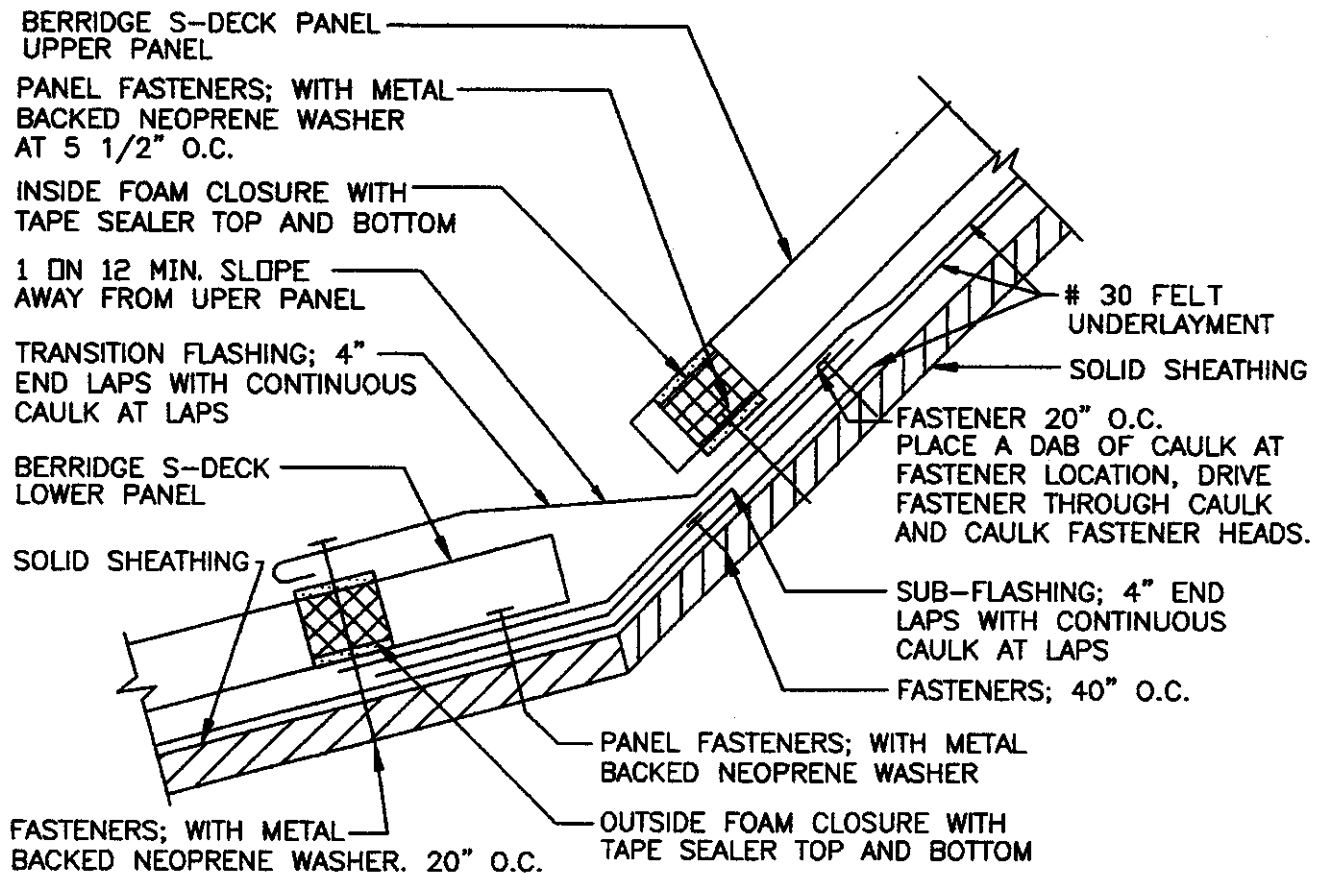

1. SOLID SHEATHING (BY OTHERS) TO BE MINIMUM 1/2" PLYWOOD OR EQUIVALENT IN STRENGTH FOR HOLDING POWER OF FASTENERS.
2. ALL FELT UNDERLAYMENT, CAULKING, AND FASTENERS, ARE ITEMS TO BE FURNISHED AND INSTALLED BY THE ROOFING INSTALLER AT THE DISCRETION OF THE ARCHITECT.

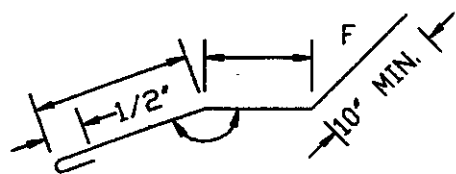

TRANSITION FLASHING

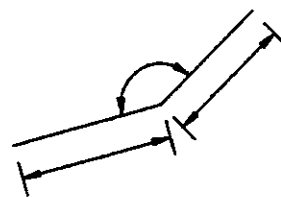

SUB-FLASHING

F = FINISH SIDE



**Berridge  
Manufacturing  
Company**

SLOPE TRANSITION DETAIL

**S-DECK SYSTEM**

DATE: 11/20/00

PAGE\FILE

**SD-60**

BERRIDGE S-DECK PANEL

CONTINUOUS BEAD OF CAULK  
BETWEEN VALLEY FLASHING  
AND FELT UNDERLAYMENT

1" EXPANDABLE  
FOAM CLOSURE  
WITH TAPE SEALER TOP  
AND BOTTOM.

FASTENERS 20" O.C. MAX.

# 30 FELT  
UNDERLAYMENT

VALLEY FLASHING  
12" END LAPS WITH (2)  
CONTINUOUS BEADS CAULK  
AT LAPS

SOLID SHEATHING

9" MIN.

PANEL FASTENER WITH  
METAL BACKED NEOPRENE  
WASHER AT 5 1/2" O.C.

1. SOLID SHEATHING (BY OTHERS) TO BE A MINIMUM OF 1/2" PLYWOOD OR EQUIVALENT IN STRENGTH FOR HOLDING POWER OF FASTENERS.
2. ALL FELT UNDERLAYMENT, CAULKING, AND FASTENERS, ARE ITEMS TO BE FURNISHED AND INSTALLED BY THE ROOFING INSTALLER AT THE DISCRETION OF THE ARCHITECT.

F = FINISH SIDE

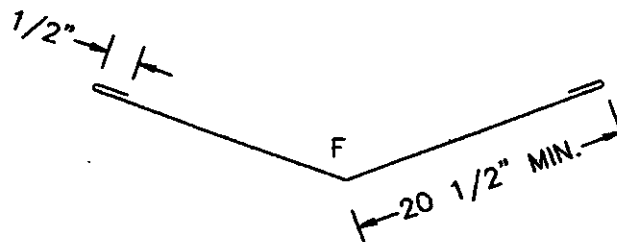

VALLEY FLASHING



**Berridge  
Manufacturing  
Company**

VALLEY DETAIL

**S-DECK SYSTEM**

DATE: 11/20/00

PAGE \ FILE

**SD-70**

BERRIDGE S-DECK PANEL  
CONTINUOUS BEAD OF CAULK  
BETWEEN VALLEY FLASHING  
AND FELT UNDERLAYMENT

1" EXPANDABLE  
FOAM CLOSURE  
WITH TAPE SEALER TOP  
AND BOTTOM

FASTENERS 20" O.C. MAX.

GRACE ICE AND  
WATERSHIELD

VALLEY FLASHING  
12" END LAPS WITH (2)  
CONTINUOUS BEADS CAULK  
AT LAPS

FLAT SHEET VALLEY SUB-FLASHING

BERRIDGE CORRUGATED S-DECK

PANEL FASTENER WITH  
METAL BACKED NEOPRENE  
WASHER AT 5 1/2" O.C.

9" MIN.

GRACE ICE AND  
WATER SHIELD  
RUN RIDGE TO EAVE

FLAT SHEET VALLEY  
SUB-FLASHING  
RUN RIDGE TO EAVE

BERRIDGE  
CORRUGATED  
S-DECK

RIDGE

SEE  
SECTION

EACH  
SIDE

EAVE

PURLINS

SLOPE

16 GA. HAT SECTION SIZED TO  
FIT OVER PURLIN AND TO  
ACCOMMODATE THE DEPTH OF THE  
BERRIDGE CORRUGATED S-DECK.

FLAT SHEET  
VALLEY SUB-FLASHING

GRACE  
ICE AND  
WATER SHIELD

16 GA.  
HAT SECTION

PURLIN

BERRIDGE  
CORRUGATED S-DECK  
SECTION

ROOFS WITH A SLOPE OF 4:12  
OR LESS 6'-0" MIN.  
ROOFS ABOVE 4:12 3'-0" MIN.

DATE: 11/20/00

VALLEY DETAIL  
OPEN FRAMING

PAGE\FILE

SD-71

S-DECK SYSTEM



Berridge  
Manufacturing  
Company

*Roofs of Distinction*



ROOF PIPE PENETRATION OF  
4" IN DIA. OR LESS

RUBBERIZED BOOT FLASHING

CONTINUOUS CAULK

PIPE PENETRATION  
NOT TO BE  
AT PANEL SIDE LAP

BERRIDGE S-DECK PANEL

SET RUBBERIZED BOOT INTO  
CONTINUOUS BEAD OF CAULK.  
USE FASTENERS AS SPECIFIED  
BY BOOT MANUFACTURER.  
CAULK FASTENER HEADS

# 30 FELT UNDERLAYMENT

SOLID SHEATHING

CUT PANEL 1" SMALLER THAN  
PENETRATION, BACK CUT TABS,  
FOLD TABS UP AROUND  
PENETRATION, AND CAULK.

NOTE: IF PIPE IS MADE OF METAL,  
IT MUST BE PAINTED TO PREVENT RUST  
RUN-OFF FROM STAINING PANELS.

NOTE: POSITION SQUARE BASED BOOTS IN A DIAMOND  
ORIENTATION WHERE POSSIBLE TO AID IN DIVERTING WATER.



**Berridge  
Manufacturing  
Company**

PIPE PENETRATION  
(PREFERRED METHOD)  
IN PAN OF PANEL ONLY  
4" DIA. OR LESS

DATE: 11/20/00

PAGE\FILE  
**SD-80**

**S-DECK SYSTEM**

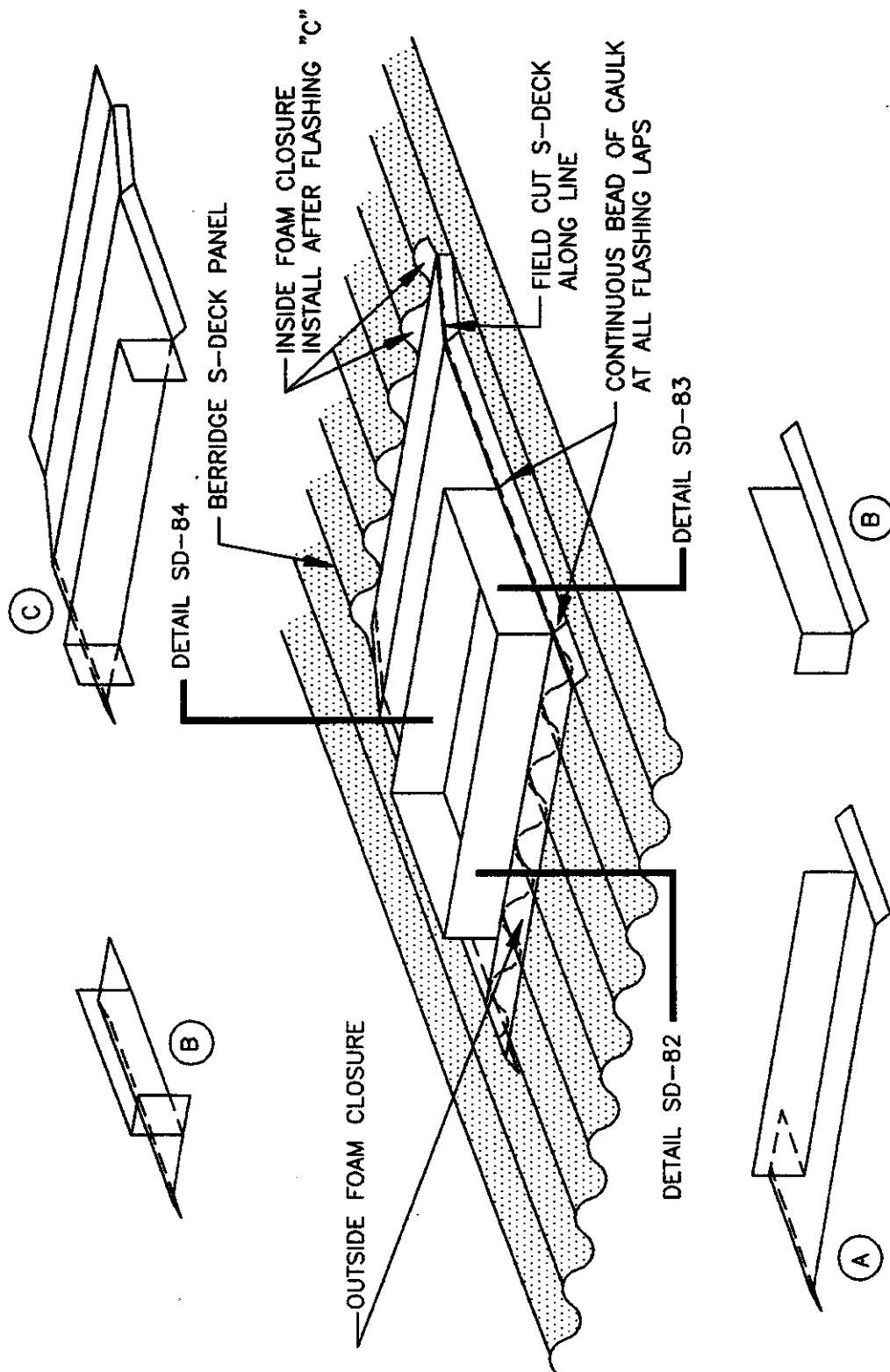

FIELD CUT PANEL ALONG DOTTED LINE AND INSTALL PANEL. INSTALL FLASHING "A" FIRST ALONG WITH FOAM CLOSURE. INSTALL FLASHING "B" SECOND. CAULK ALL FLASHING LAPS. INSTALL FLASHING "C" LAST. THIS FLASHING IS TO BE SLIPPED UNDER THE S-DECK PANEL AND FELT AS SHOWN IN DETAIL SD-84 BEFORE THE FOAM CLOSURE OR FASTENERS ARE INSTALLED. SEE ALSO DETAILS SD-82 AND SD-83 FOR FELTING AND SUBFLASHING.

DATE: 11/20/00

PAGE\FILE  
SD-81

# ROOF PENETRATION **S-DECK SYSTEM**



**Berridge**  
**Manufacturing**  
**Company**

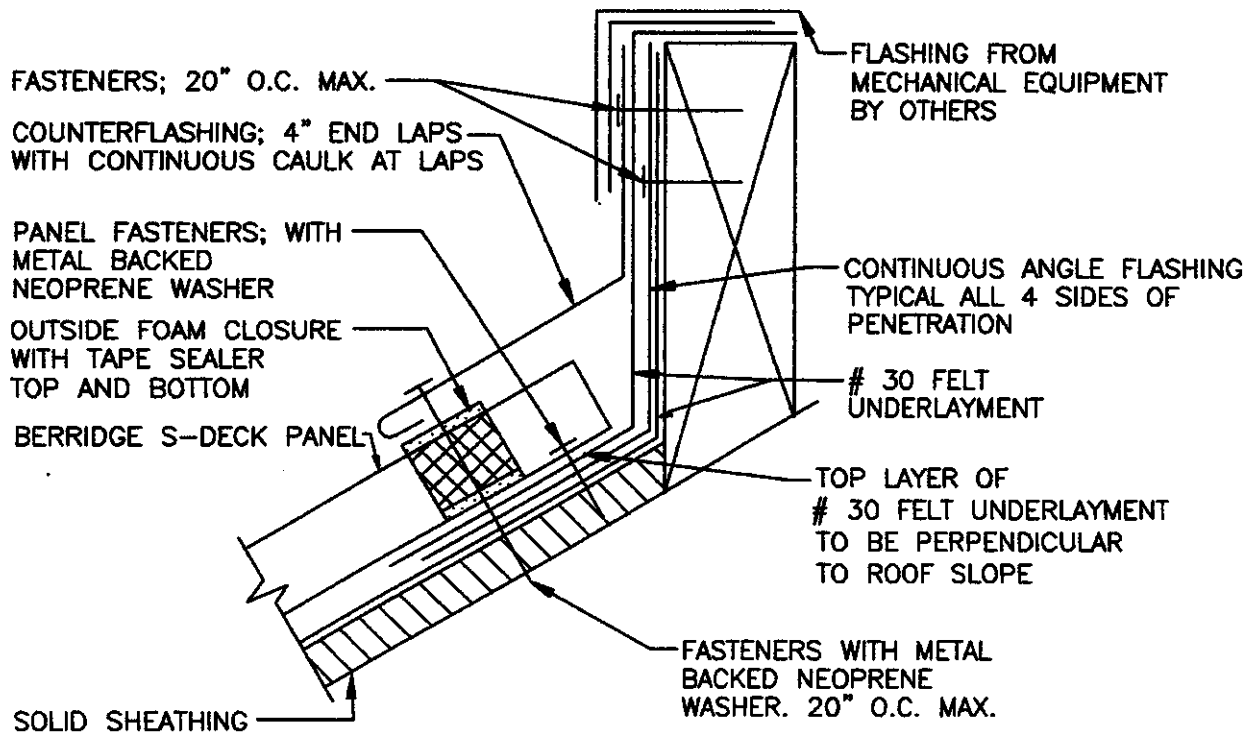

1. SOLID SHEATHING (BY OTHERS) TO BE MINIMUM 1/2" PLYWOOD OR EQUIVALENT IN STRENGTH FOR HOLDING POWER OF FASTENERS.
2. ALL FELT UNDERLAYMENT, CAULKING, AND FASTENERS, ARE ITEMS TO BE FURNISHED AND INSTALLED BY THE ROOFING INSTALLER AT THE DISCRETION OF THE ARCHITECT.

F = FINISH SIDE

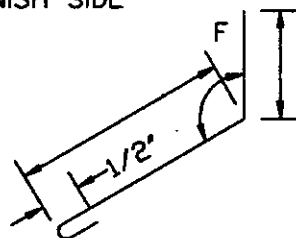

COUNTER FLASHING  
SIDE A

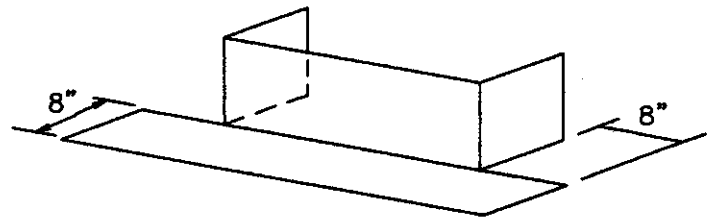

ANGLE FLASHING



**Berridge  
Manufacturing  
Company**

ROOF PENITRATION  
SIDE A

**S-DECK SYSTEM**

DATE: 11/20/00

PAGE\FILE  
**SD-82**

FLASHING FROM  
MECHANICAL EQUIPMENT  
BY OTHERS

FASTENERS; 20" O.C. TYP.

# 30 FELT  
UNDERLAYMENT

CONTINUOUS ANGLE  
TYPICAL ALL 4 SIDES  
OF PENETRATION

1" EXPANDABLE FOAM CLOSURE  
WITH TAPE SEALER TOP AND  
BOTTOM

TOP LAYER OF FELT TO  
BE PARALLEL WITH ROOF  
SLOPE

SOLID SHEATHING

RAKE CHANNEL 4" END LAPS  
WITH CONTINUOUS CAULK  
AT LAPS

# 30 FELT  
UNDERLAYMENT

COUNTER FLASHING  
4" END LAPS WITH  
CONTINUOUS CAULK AT LAPS

CONTINUOUS BEAD OF CAULK

BERRIDGE S-DECK PANEL

# 30 FELT  
UNDERLAYMENT

FASTENER 20" O.C. PLACE  
A DAB OF CAULK AT FASTENER  
LOCATION DRIVE FASTENER AND  
CAULK FASTENER HEAD

1. SOLID SHEATHING (BY OTHERS) TO BE MINIMUM 1/2" PLYWOOD OR EQUIVALENT IN STRENGTH FOR HOLDING POWER OF FASTENERS.
2. ALL FELT UNDERLAYMENT, CAULKING, AND FASTENERS, ARE ITEMS TO BE FURNISHED AND INSTALLED BY THE ROOFING INSTALLER AT THE DISCRETION OF THE ARCHITECT.

F = FINISH SIDE

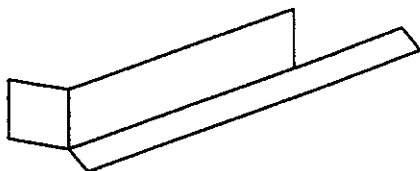

ANGLE FLASHING  
SIDE B

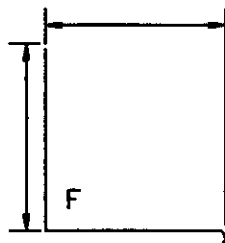

COUNTER FLASHING

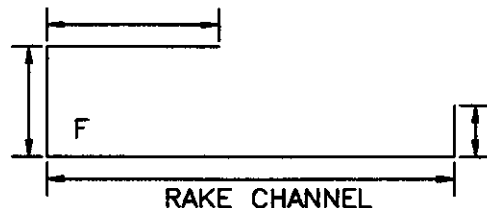

RAKE CHANNEL

DATE: 11/20/00

ROOF PENETRATION  
SIDE B

PAGE\FILE

SD-83

**S-DECK SYSTEM**



**Berridge  
Manufacturing  
Company**

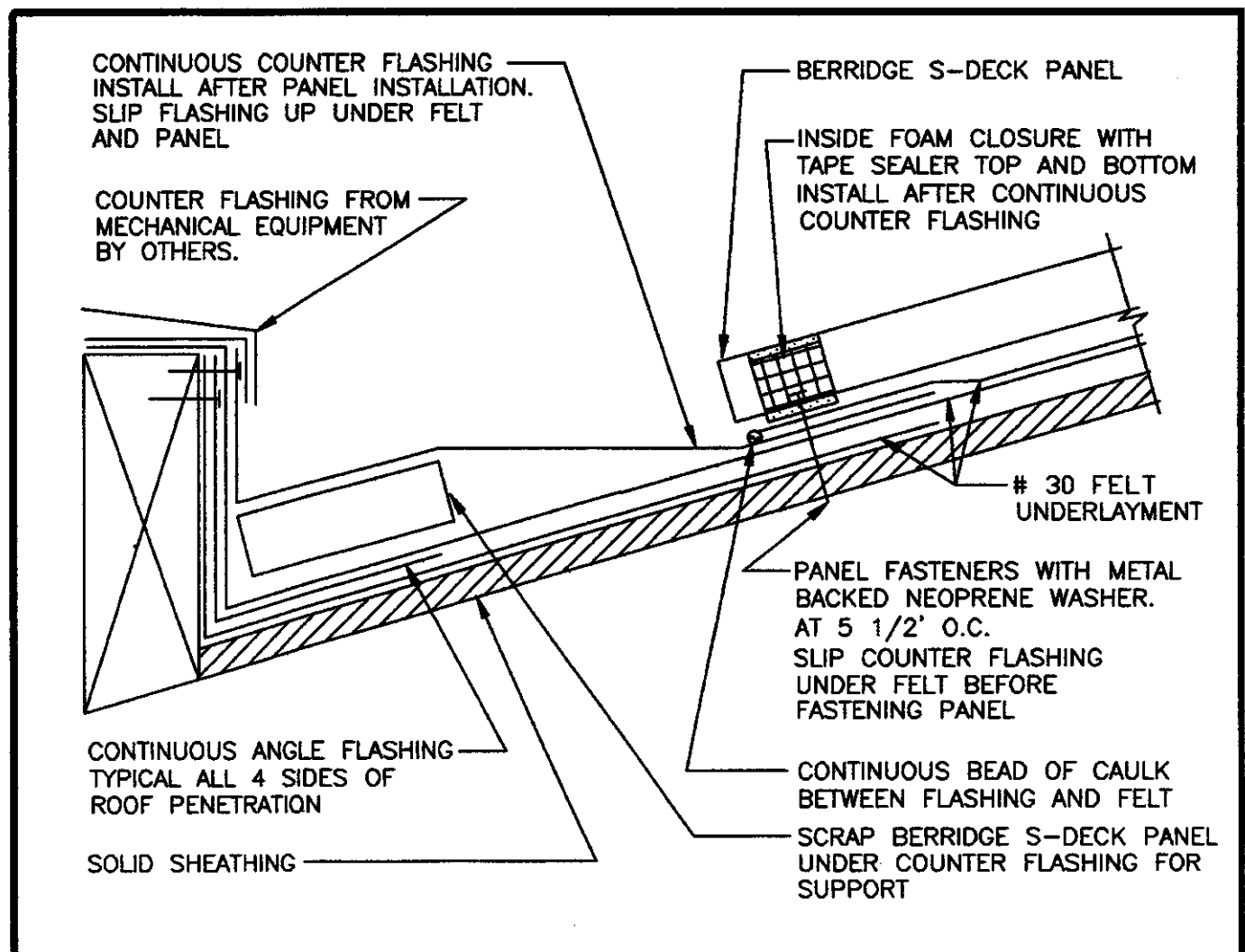

1. SOLID SHEATHING (BY OTHERS) TO BE MINIMUM 1/2" PLYWOOD OR EQUIVALENT IN STRENGTH FOR HOLDING POWER OF FASTENERS.
2. ALL FELT UNDERLAYMENT, CAULKING, AND FASTENERS, ARE ITEMS TO BE FURNISHED AND INSTALLED BY THE ROOFING INSTALLER AT THE DISCRETION OF THE ARCHITECT.

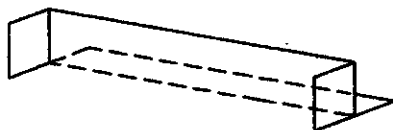

ANGLE FLASHING

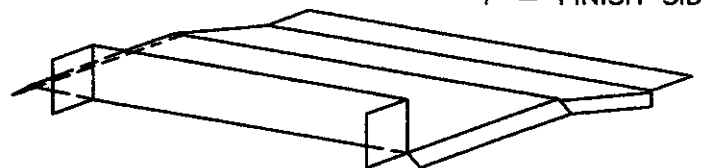

COUNTER FLASHING  
SIDE C



**Berridge  
Manufacturing  
Company**

ROOF PENETRATION  
SIDE C

**S-DECK SYSTEM**

DATE: 11/20/00

PAGE\FILE  
**SD-84**

FOR ROOF PENETRATIONS  
LARGER THAN 4" IN DIA.

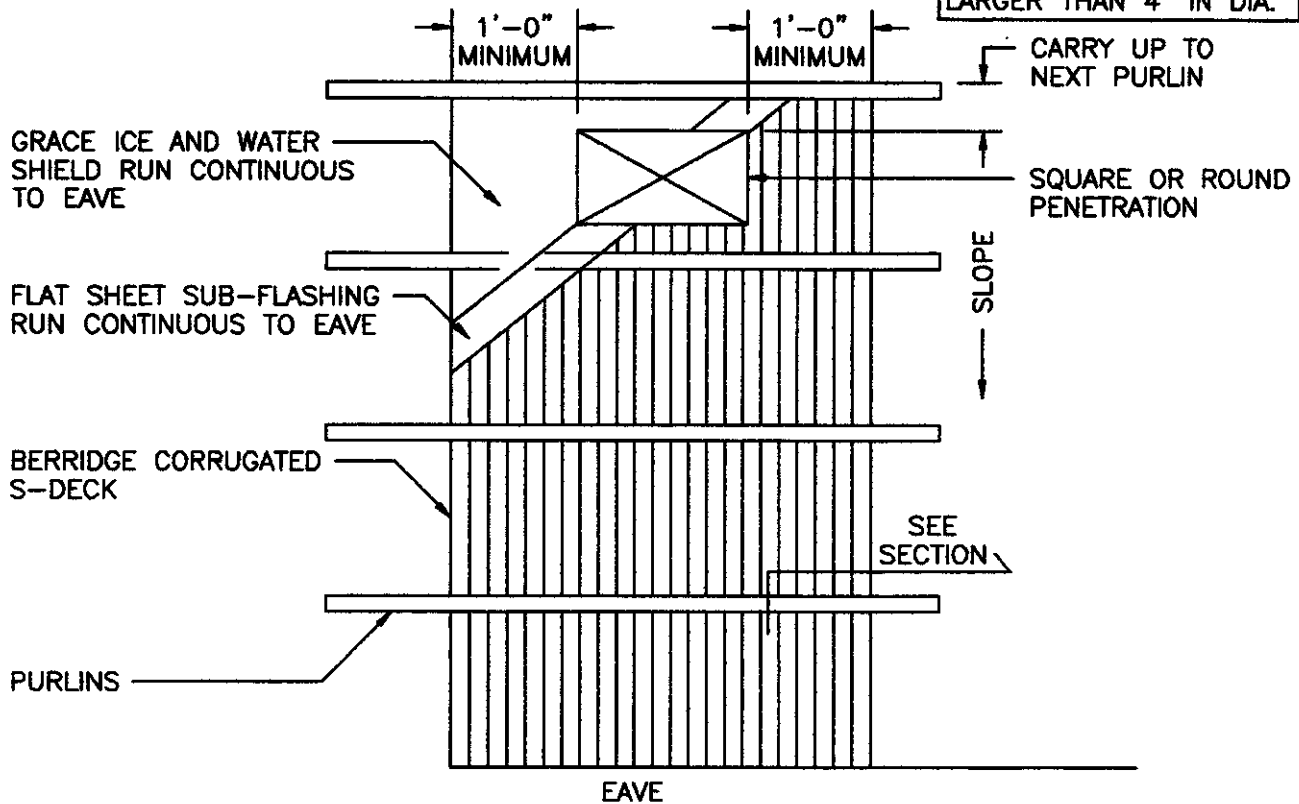

16 GA. HAT SECTION SIZE  
TO FIT OVER PURLIN AND TO  
ACCOMMODATE THE DEPTH OF THE  
BERRIDGE CORRUGATED S-DECK.

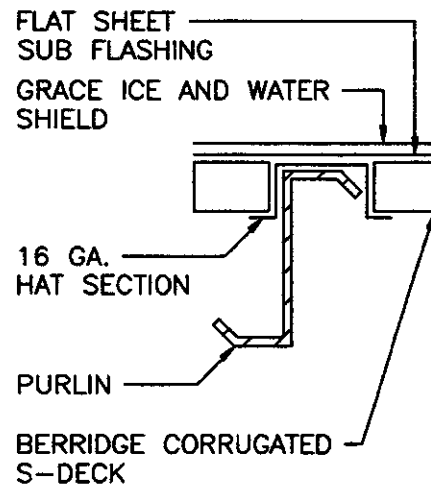
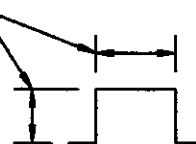

SECTION

DATE: 11/20/00

PAGE\FILE  
SD-85

PENETRATION  
LARGER THAN 4"  
OPEN FRAMING

**S-DECK SYSTEM**



**Berridge  
Manufacturing  
Company**

BERRIDGE S-DECK PANEL

CONTINUOUS BEADS OF CAULK

INSIDE CORNER FLASHING; 4" END LAPS WITH  
CONTINUOUS CAULK AT LAPS

POP RIVET 20" O.C.

RAKE CHANNEL; 4" END LAPS  
WITH CONTINUOUS CAULK AT LAPS.

1" EXPANDABLE FOAM CLOSURE WITH TAPE  
SEALER TOP AND BOTTOM

SUB-FLASHING; 4" END LAPS WITH  
CONTINUOUS CAULK AT LAPS

FASTENERS 20" O.C. PLACE A  
DAB OF CAULK AT FASTENER  
LOCATION DRIVE FASTENER AND  
CAULK FASTENER HEAD.

SOLID SHEATHING

# 30 FELT UNDERLAYMENT

FASTENERS; 20" O.C. MAX.

1. SOLID SHEATHING (BY OTHERS) TO BE MINIMUM 1/2" PLYWOOD OR EQUIVALENT IN STRENGTH FOR HOLDING POWER OF FASTENERS.
2. ALL FELT UNDERLAYMENT, CAULKING, AND FASTENERS, ARE ITEMS TO BE FURNISHED AND INSTALLED BY THE ROOFING INSTALLER AT THE DISCRETION OF THE ARCHITECT.

F = FINISH SIDE

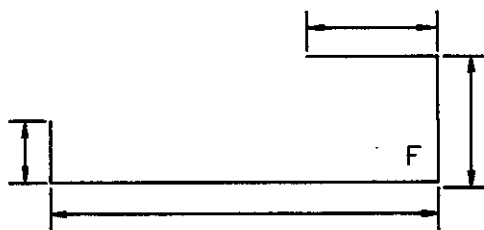

RAKE CHANNEL

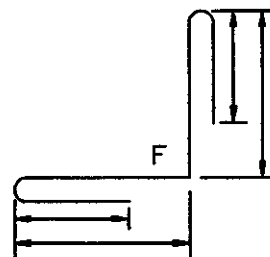

CORNER FLASHING

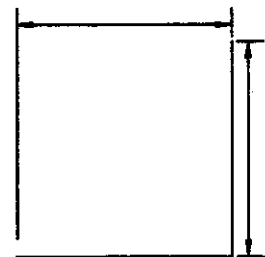

SUB-FLASHING



**Berridge  
Manufacturing  
Company**

INSIDE CORNER  
SOLID SHEATHING

**S-DECK SYSTEM**

DATE: 11/20/00

PAGE\FILE  
**SD-90**

OUTSIDE CORNER FLASHING; 4" END LAPS  
WITH CONTINUOUS CAULK AT LAPS.

POP RIVET 20" O.C.

CONTINUOUS BEADS OF CAULK

BERRIDGE S-DECK PANEL

RAKE CHANNEL; 4" END LAPS  
WITH CONTINUOUS CAULK AT LAPS.

# 30 FELT UNDERLAYMENT

SUB-FLASHING; 4" END LAPS WITH  
CONTINUOUS CAULK AT LAPS

1" EXPANDABLE FOAM CLOSURE WITH TAPE  
SEALER TOP AND BOTTOM.

FASTENERS; 20" O.C. MAX.

FASTENERS; 20" O.C. PLACE A  
DAB OF CAULK AT FASTENER  
LOCATION DRIVE FASTENER AND  
CAULK FASTENER HEAD.

SOLID SHEATHING

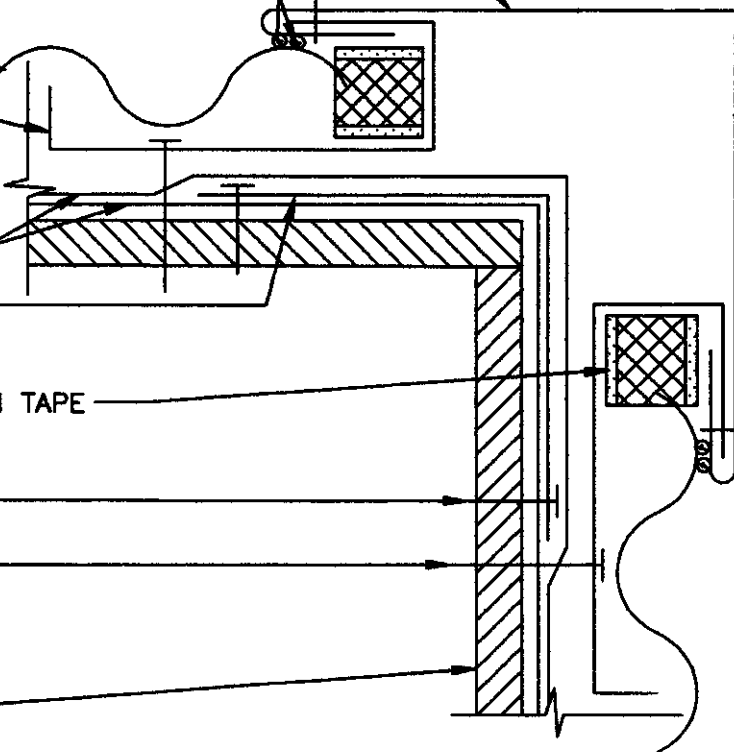

1. SOLID SHEATHING (BY OTHERS) TO BE MINIMUM 1/2" PLYWOOD OR EQUIVALENT IN  
STRENGTH FOR HOLDING POWER OF FASTENERS.

2. ALL FELT UNDERLAYMENT, CAULKING, AND FASTENERS, ARE ITEMS TO BE FURNISHED  
AND INSTALLED BY THE ROOFING INSTALLER AT THE DISCRETION OF THE ARCHITECT.

F = FINISH SIDE

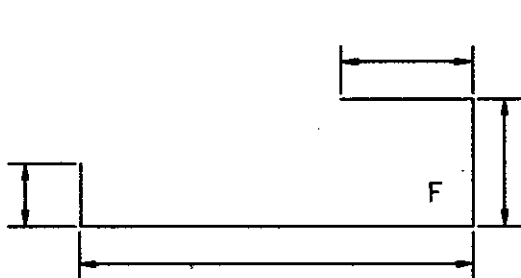

RAKE CHANNEL

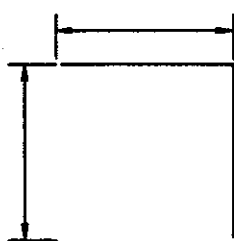

SUB-FLASHING

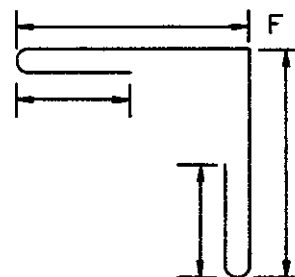

OUTSIDE CORNER FLASHING

DATE: 11/20/00

PAGE\FILE  
SD-91

OUTSIDE CORNER  
SOLID SHEATHING

**S-DECK SYSTEM**



**Berridge  
Manufacturing  
Company**

*Roofs of Distinction*



BERRIDGE S-DECK PANEL

CONTINUOUS BEADS OF CAULK

INSIDE CORNER FLASHING; 4" END LAPS WITH  
CONTINUOUS CAULK AT LAPS

POP RIVET 20" O.C.

RAKE CHANNEL; 4" END LAPS  
WITH CONTINUOUS CAULK AT LAPS

1" EXPANDABLE FOAM CLOSURE WITH TAPE  
SEALER TOP AND BOTTOM

SUB-FLASHING; 4" END LAPS WITH  
CONTINUOUS CAULK AT LAPS

PURLIN

FASTENERS; AT PURLINS

FASTENERS 20" O.C. PLACE A  
DAB OF CAULK AT FASTENER  
LOCATION DRIVE FASTENER AND  
CAULK FASTENER HEAD.

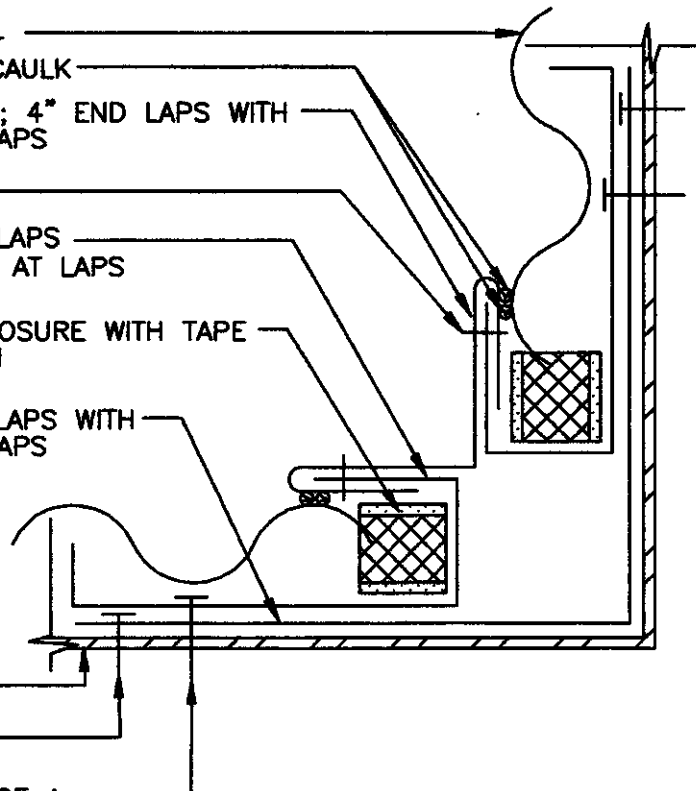

1. ALL CAULKING, AND FASTENERS, ARE ITEMS TO BE FURNISHED  
AND INSTALLED BY THE ROOFING INSTALLER AT THE DISCRETION OF THE ARCHITECT.

F = FINISH SIDE

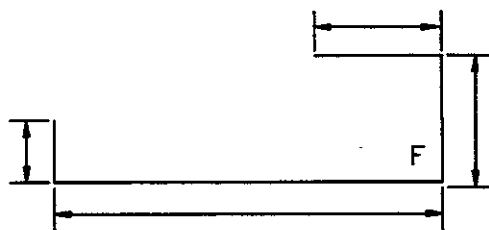

RAKE CHANNEL

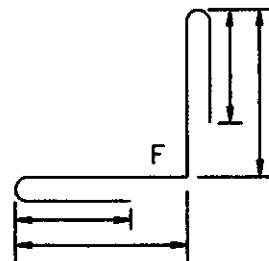

CORNER FLASHING

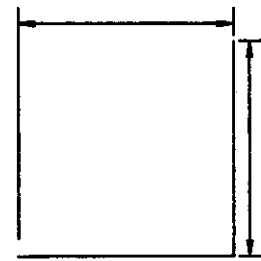

SUB-FLASHING



**Berridge  
Manufacturing  
Company**

INSIDE CORNER  
OPEN FRAMING

**S-DECK SYSTEM**

DATE: 11/20/00

PAGE\FILE  
**SD-92**

OUTSIDE CORNER FLASHING; 4" END LAPS  
WITH CONTINUOUS CAULK AT LAPS

POP RIVET 20" O.C.

CONTINUOUS BEADS OF CAULK

BERRIDGE S-DECK PANEL

RAKE CHANNEL; 4" END LAPS  
WITH CONTINUOUS CAULK AT LAPS

FASTENERS AT PURLINS

FASTENERS; 20" O.C. PLACE A  
DAB OF CAULK AT FASTENER  
LOCATION DRIVE FASTENER AND  
CAULK FASTENER HEAD

SUB-FLASHING; 4" END LAPS WITH  
CONTINUOUS CAULK AT LAPS

1" EXPANDABLE FOAM CLOSURE WITH TAPE  
SEALER TOP AND BOTTOM

PURLIN

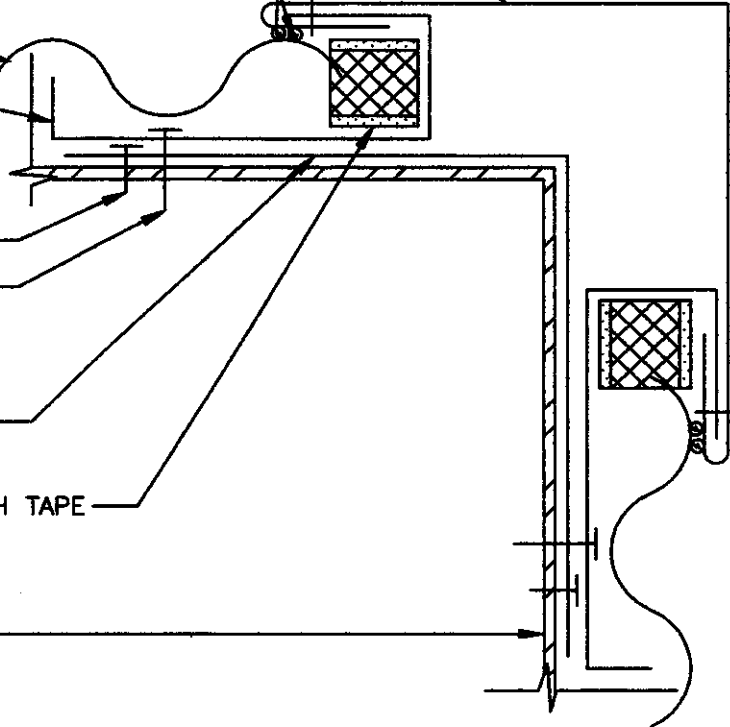

1. ALL CAULKING, AND FASTENERS, ARE ITEMS TO BE FURNISHED  
AND INSTALLED BY THE ROOFING INSTALLER AT THE DISCRETION OF THE ARCHITECT.

F = FINISH SIDE

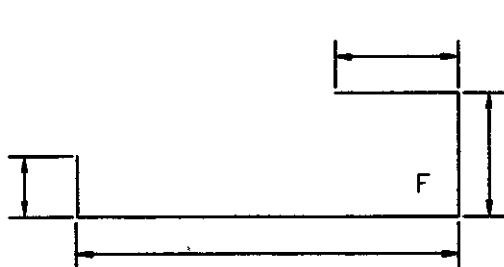

RAKE CHANNEL

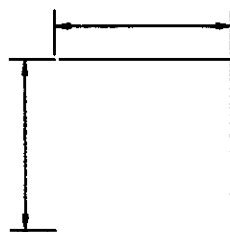

SUB-FLASHING

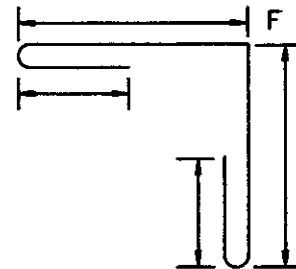

OUTSIDE CORNER FLASHING

DATE: 11/20/00

PAGE\FILE  
SD-93

OUTSIDE CORNER  
OPEN FRAMING

**S-DECK SYSTEM**



**Berridge  
Manufacturing  
Company**

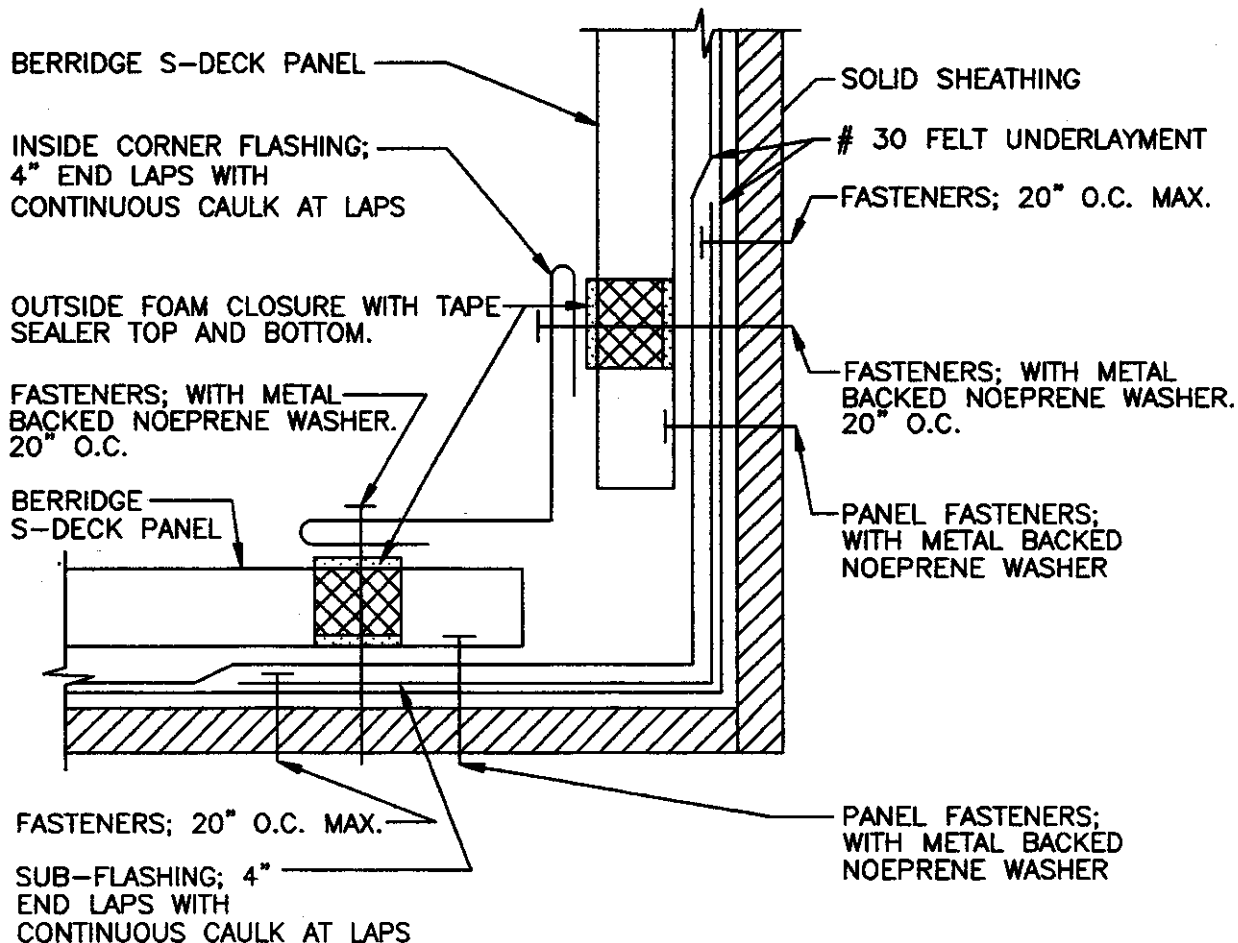

1. SOLID SHEATHING (BY OTHERS) TO BE MINIMUM 1/2" PLYWOOD OR EQUIVALENT IN STRENGTH FOR HOLDING POWER OF FASTENERS.
2. ALL FELT UNDERLAYMENT, CAULKING, AND FASTENERS, ARE ITEMS TO BE FURNISHED AND INSTALLED BY THE ROOFING INSTALLER AT THE DISCRETION OF THE ARCHITECT.

F = FINISH SIDE

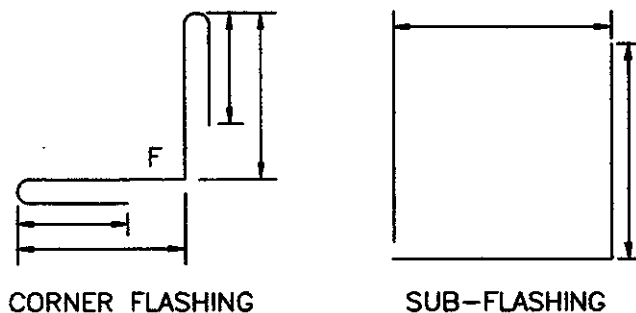

**Berridge  
Manufacturing  
Company**

INSIDE CORNER  
SOLID SHEATHING

**S-DECK SYSTEM**

DATE: 11/20/00

PAGE\FILE

**SD-94**

OUTSIDE CORNER FLASHING; 4" END LAPS  
WITH CONTINUOUS CAULK AT LAPS.

PANEL FASTENERS; WITH METAL  
BACKED NEOPRENE WASHER.

FASTENERS; WITH METAL  
BACKED NEOPRENE WASHER.  
20" O.C.

BERRIDGE S-DECK PANEL

# 30 FELT UNDERLAYMENT

FASTENERS; 20" O.C. MAX.

SUB-FLASHING; 4" END LAPS WITH  
CONTINUOUS CAULK AT LAPS

OUTSIDE FOAM CLOSURE WITH TAPE  
SEALER TOP AND BOTTOM.

FASTENERS; WITH METAL  
BACKED NEOPRENE WASHER.  
20" O.C.

FASTENERS; 20" O.C. MAX.

BERRIDGE S-DECK PANEL

SOLID SHEATHING

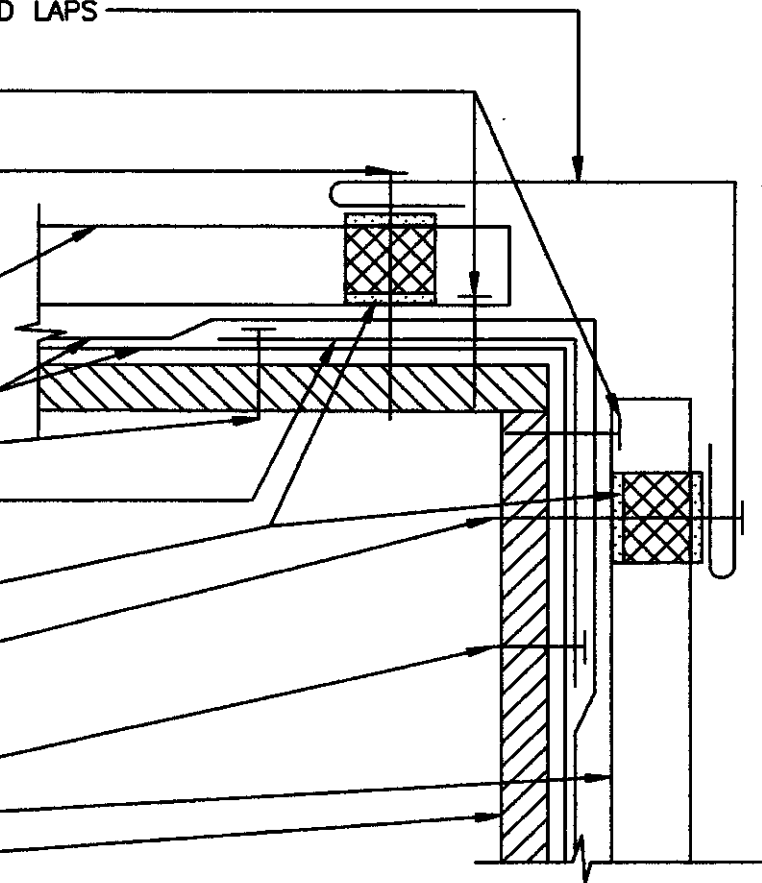

1. SOLID SHEATHING (BY OTHERS) TO BE MINIMUM 1/2" PLYWOOD OR EQUIVALENT IN  
STRENGTH FOR HOLDING POWER OF FASTENERS.

2. ALL FELT UNDERLAYMENT, CAULKING, AND FASTENERS, ARE ITEMS TO BE FURNISHED  
AND INSTALLED BY THE ROOFING INSTALLER AT THE DISCRETION OF THE ARCHITECT.

F = FINISH SIDE

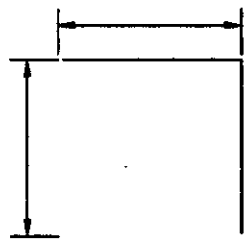

SUB-FLASHING

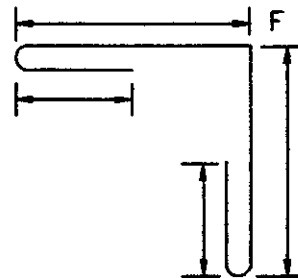

OUTSIDE CORNER FLASHING

DATE: 11/20/00

PAGE\FILE  
SD-95

OUTSIDE CORNER  
SOLID SHEATHING

**S-DECK SYSTEM**



**Berridge  
Manufacturing  
Company**

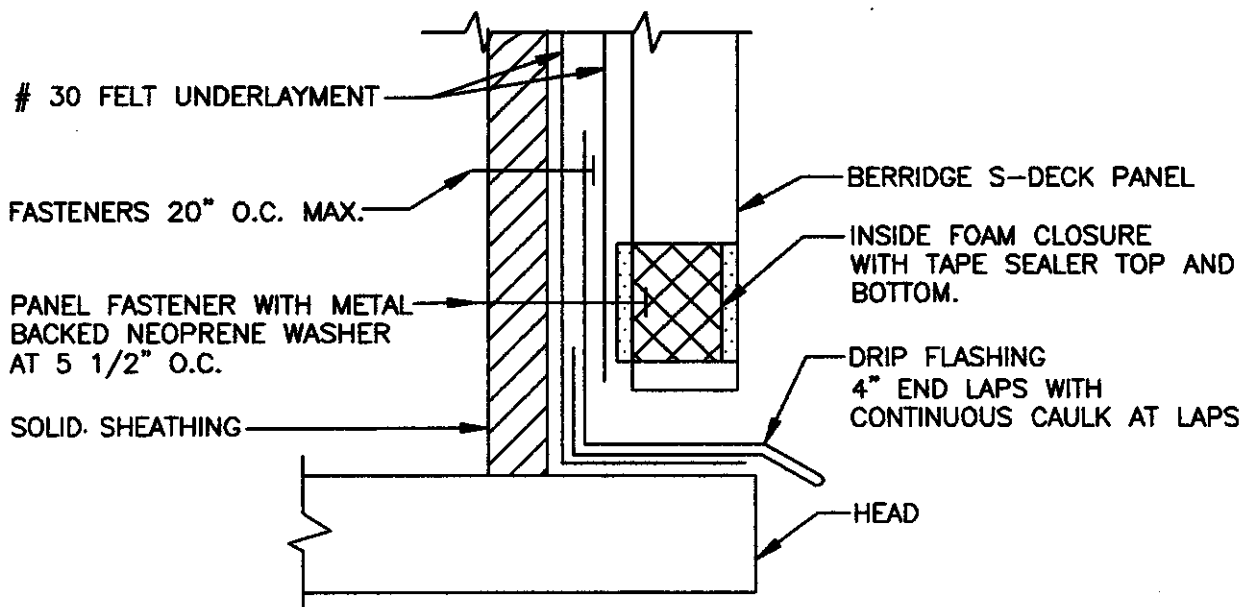

1. SOLID SHEATHING (BY OTHERS) TO BE MINIMUM 1/2" PLYWOOD OR EQUIVALENT IN STRENGTH FOR HOLDING POWER OF FASTENERS.
2. ALL FELT UNDERLAYMENT, CAULKING, AND FASTENERS, ARE ITEMS TO BE FURNISHED AND INSTALLED BY THE ROOFING INSTALLER AT THE DISCRETION OF THE ARCHITECT.

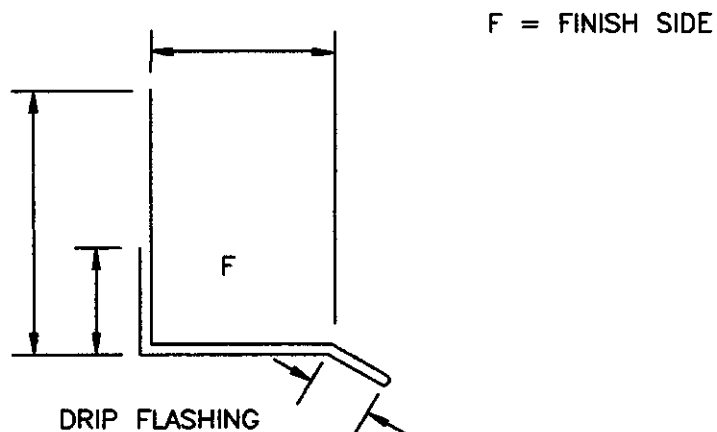

**Berridge  
Manufacturing  
Company**

HEAD DETAIL  
SOLID SHEATHING

**S-DECK SYSTEM**

DATE: 11/20/00

PAGE\FILE  
**SD-96**

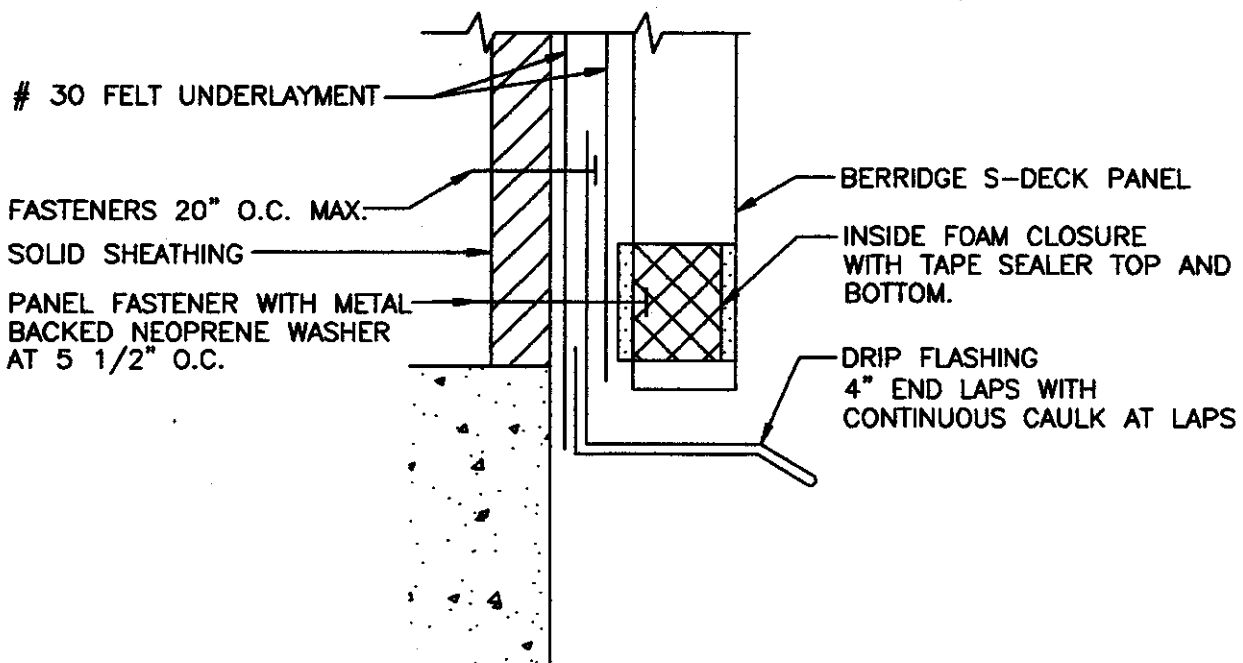

1. SOLID SHEATHING (BY OTHERS) TO BE MINIMUM 1/2" PLYWOOD OR EQUIVALENT IN STRENGTH FOR HOLDING POWER OF FASTENERS.
2. ALL FELT UNDERLAYMENT, CAULKING, AND FASTENERS, ARE ITEMS TO BE FURNISHED AND INSTALLED BY THE ROOFING INSTALLER AT THE DISCRETION OF THE ARCHITECT.

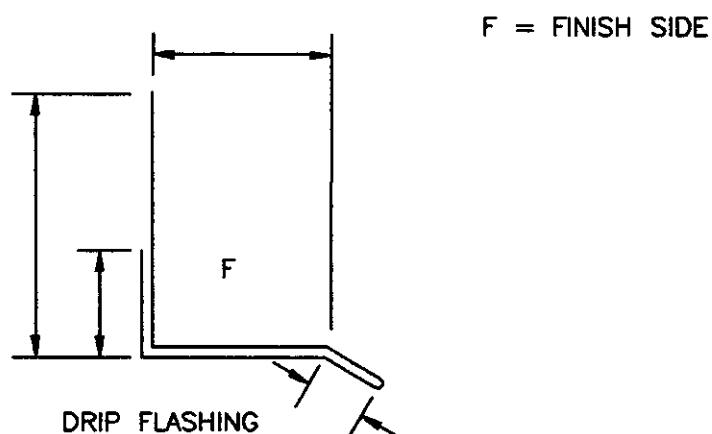

DATE: 11/20/00

PAGE\FILE  
SD-97

SLAB DETAIL  
SOLID SHEATHING

**S-DECK SYSTEM**



**Berridge  
Manufacturing  
Company**

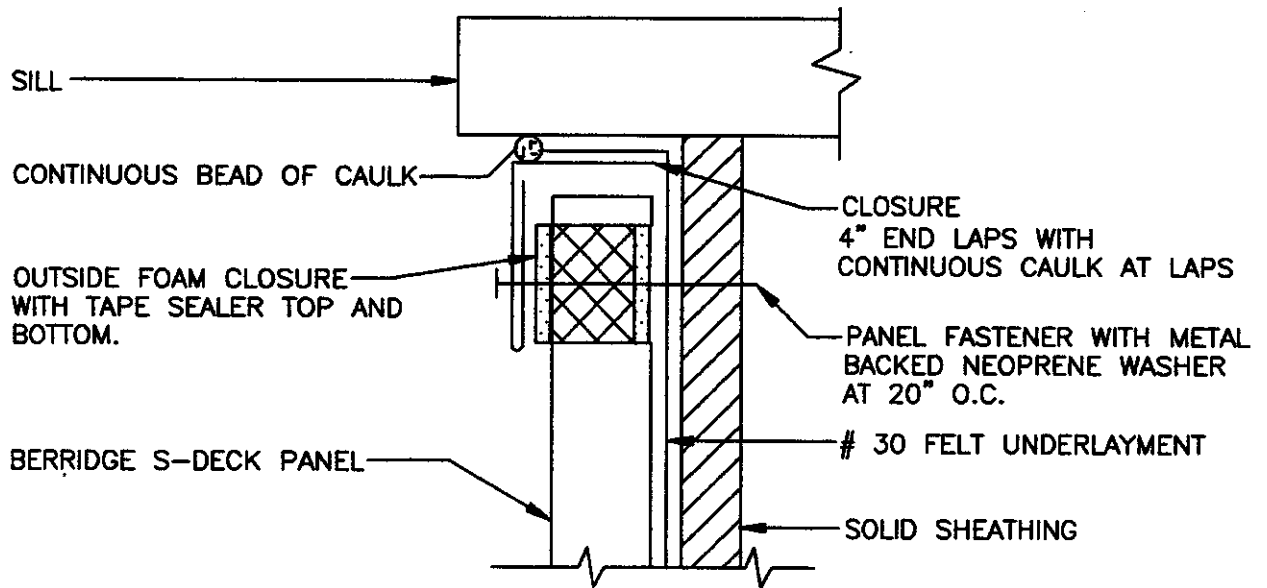

1. SOLID SHEATHING (BY OTHERS) TO BE MINIMUM 1/2" PLYWOOD OR EQUIVALENT IN STRENGTH FOR HOLDING POWER OF FASTENERS.
2. ALL FELT UNDERLAYMENT, CAULKING, AND FASTENERS, ARE ITEMS TO BE FURNISHED AND INSTALLED BY THE ROOFING INSTALLER AT THE DISCRETION OF THE ARCHITECT.

F = FINISH SIDE

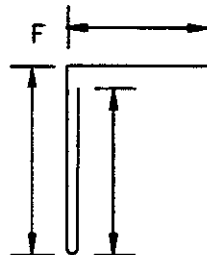

CLOSURE



**Berridge  
Manufacturing  
Company**

SILL DETAIL  
SOLID SHEATHING

**S-DECK SYSTEM**

DATE: 11/20/00

PAGE\FILE  
**SD-98**

FASTENER 20" O.C. PLACE  
A DAB OF CAULK AT FASTENER  
LOCATION DRIVE FASTENER AND  
CAULK FASTENER HEAD

GABLE CHANNEL 4" END LAPS  
WITH CONTINUOUS CAULK  
AT LAPS

1" EXPANDABLE FOAM CLOSURE  
WITH TAPE SEALER TOP AND  
BOTTOM.

# 30 FELT  
UNDERLAYMENT

BERRIDGE S-DECK PANEL

JAMB

CONTINUOUS BEAD OF CAULK

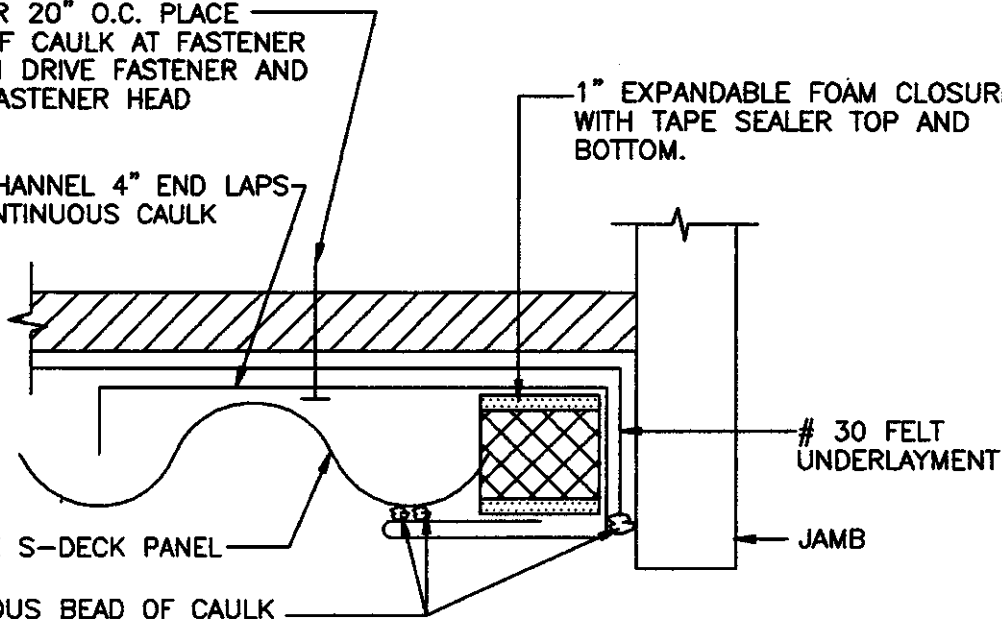

1. SOLID SHEATHING (BY OTHERS) TO BE MINIMUM 1/2" PLYWOOD OR EQUIVALENT IN STRENGTH FOR HOLDING POWER OF FASTENERS.
2. ALL FELT UNDERLAYMENT, CAULKING, AND FASTENERS, ARE ITEMS TO BE FURNISHED AND INSTALLED BY THE ROOFING INSTALLER AT THE DISCRETION OF THE ARCHITECT.

F = FINISH SIDE

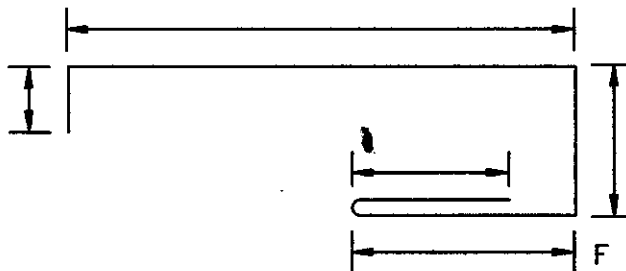

GABLE CHANNEL

DATE: 11/20/00

JAMB DETAIL  
SOLID SHEATHING

PAGE\FILE

SD-99

**S-DECK SYSTEM**



**Berridge  
Manufacturing  
Company**